

## PE80 Series Exit Devices

### Electrical Wiring and Wire Routing for:

- 53- Prefix (Latch Monitor Switch)
- 54- Prefix (Exit Trim Lever Monitor Switch)
- 55- Prefix (Push Bar Signal Switch)
- 58- Prefix (Electric Dogging)
- P773, P774, P775, P776 (Electromechanical Exit Trim)
- PW773, PW774, PW775, PW776 (Electromechanical Wide Exit Trim)

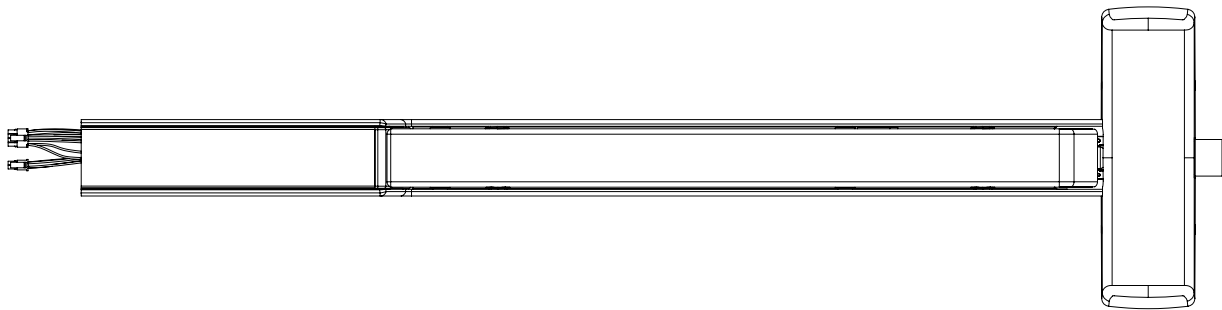

### WARNING

This product can expose you to lead which is known to the state of California to cause cancer and birth defects or other reproductive harm. For more information go to [www.P65warnings.ca.gov](http://www.P65warnings.ca.gov).

TOC	Table of Contents
1	Function .....3
2	General Description..... 3
3	Specifications .....3
4	ElectroLynx Connector System Notes .....4
5	Wire Routing.....5
6	PE80 Series Device Installation and Wiring Overview ..... 16
7	53-Prefix (Latch Monitor Switch) - Exit Device to Frame Connection ..... 17
8	54- Prefix (Trim Monitor Switch) - Exit Device to Frame Connection..... 18
9	55- Prefix Push Bar (Signal Switch) - Exit Device to Frame Connection..... 19
10	58- Prefix (Electric Dogging) - Exit Device to Frame Connection..... 20
11	P/PW773, P/PW774, P/PW775, P/PW776 (Electromechanical Exit Trim) - Exit Device to Frame Connection ..... 21
12	Appendix A: Harness Wiring Reconfiguration..... 23

**Note:** The 55-, 53-, 58-, P/PW773, P/PW774, P/PW775, P/PW776, and 54- options are combined into this one instruction.

## 1

### Function

- The 55- prefix signal switch monitors the touch bar. When the rail is depressed or dogged, the switch is de-activated.
- The 53- prefix latchbolt monitor switch provides positive indication of latchbolt extension or retraction when the push rail is depressed, dogged or if the latch bolt itself is depressed.
- When the 58-PE80 series exit device is energized and the rail is depressed, it will continuously hold the push rail down and latch in an unlocked (dogged) position. When the device is de-energized (or power is interrupted), the latch will extend.
- P/PW773, P/PW774, P/PW775, P/PW776 Electromechanical Trims
- 54-prefix signal switch monitors the outside lever. When the lever is rotated, the switch is deactivated.

## 2

### General Description

This instruction manual includes wiring instructions for all Premium Exit (PE80) Series Electrified Exits Options to ElectroLynx connector system. The correct wiring configuration must be selected depending on type and function of the product being installed. Refer to table of contents to select appropriate wiring instruction for product options being installed. Options/prefixes can be combined and wired together, as ordered.

## 3

### Specifications

#### Electromechanical Exit Trim

##### Fail Safe Models:

P/PW773 without cylinder  
P/PW775 with cylinder

##### Fail Secure Models:

P/PW774 without cylinder  
P/PW776 with cylinder

##### Motor

Type: 12 or 24VDC, Intermittent or Continuous Duty  
Current draw is 400mA inrush / 15mA continuous @12VDC / 24VDC



**Caution:** The DC voltage applied to the electromechanical exit trim must not exceed 30VDC. If the voltage exceeds 30VDC the motor may be damaged.

53-, 54-, and -55- switch contact rating: 1A max @ 30VDC

53- prefix (latch monitor switch)

54- prefix (exit trim lever monitor switch)

55- prefix (push bar signal monitor switch)

58- prefix (electric dogging) Electromagnet current: 200mA @ 24VDC



**Caution:** Disconnect all input power before beginning installation to prevent electrical shock and equipment damage. All wiring must comply with applicable local electrical codes, ordinances and regulations. Installer must be a trained, experienced service person.

The system is designed to be installation friendly with quick connectors from the electric hinge through the door to the rail. The only wiring required is to the loose wires on the pigtail harness assembly on the frame side of the electric hinge.

**Important:** The plug and receptacle connectors are designed to mate and lock together as shown in the figure. Plug the connectors into each other with the locking mechanism aligned as indicated.

**Do not force connectors on any other way.**

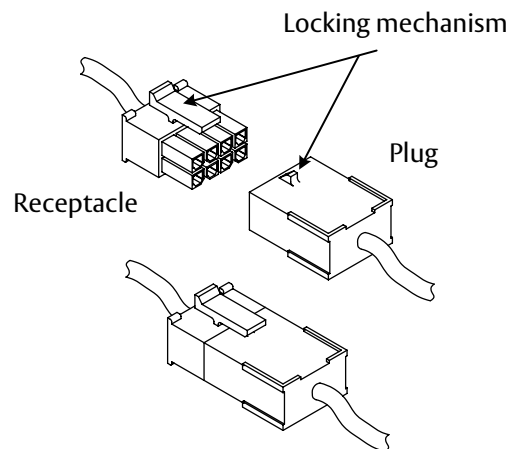

**These notes apply to all of the following devices concerning the installation and wiring to the ElectroLynx Connector System**

1. With new applications, a raceway harness with 8 and 4 pin connectors will be pre-installed inside door by ASSA ABLOY door manufacturer when specified during the ordering process. Raceway harness kits are also available for retrofit applications.
2. If door does not have a raceway harness with connectors, cut connectors off product, or consult factory for raceway retrofit kit.
3. Wiring to pigtail harness is per facility wiring requirement. The rail, raceway, electric hinge and pigtail connector terminations and wire colors all match.

## 5 Wire Routing

### 8300 OVERVIEW

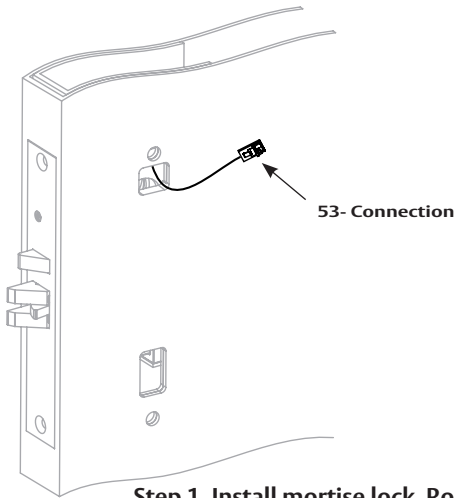
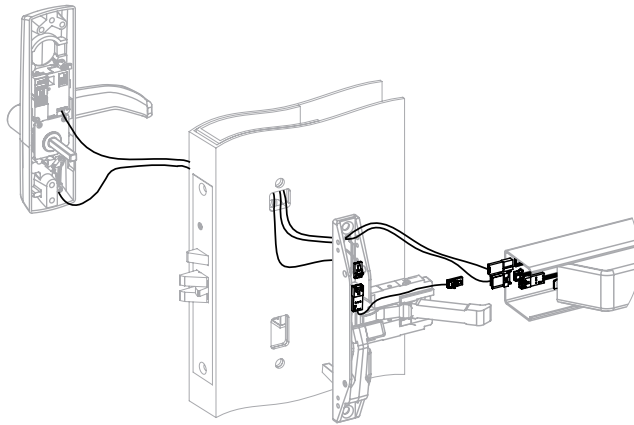

Step 1. Install mortise lock. Route wire as shown.

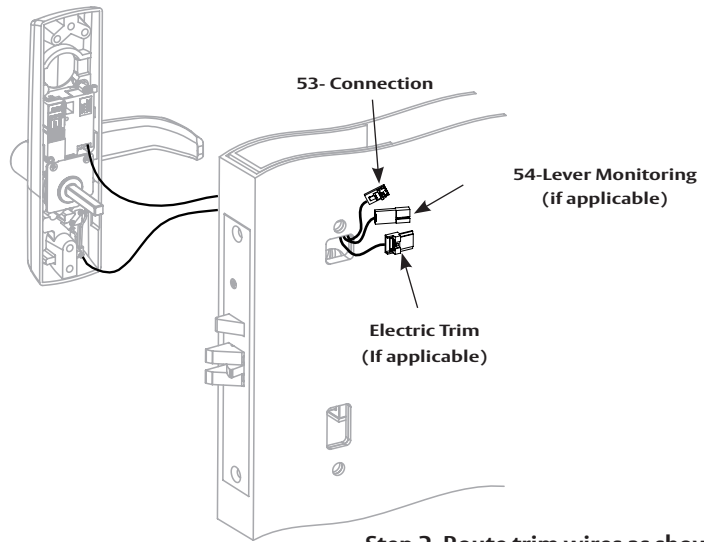

Step 2. Route trim wires as shown.

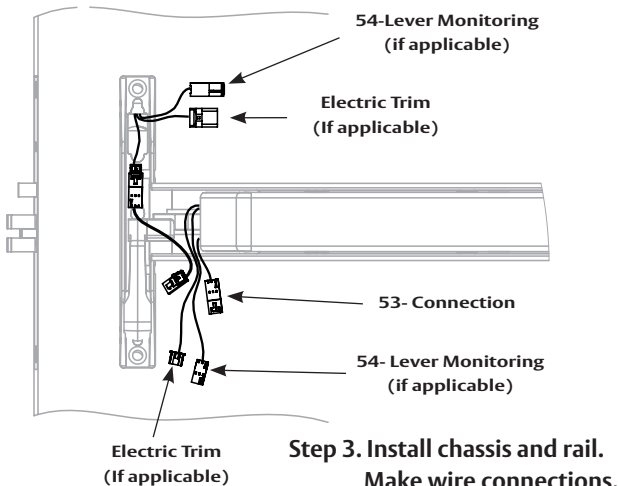

Step 3. Install chassis and rail. Make wire connections.

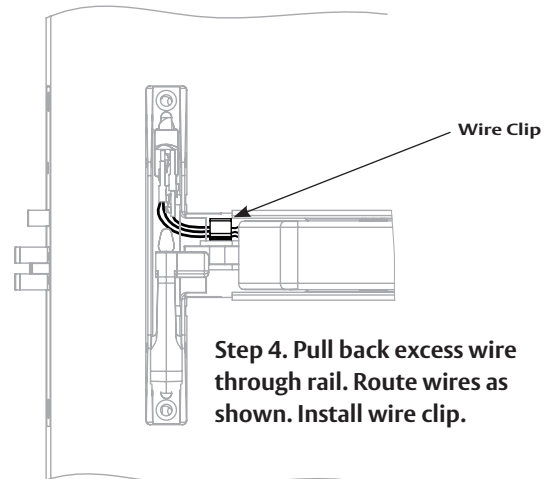

Step 4. Pull back excess wire through rail. Route wires as shown. Install wire clip.

#### 5

### Wire Routing - continued

#### 8400 OVERVIEW

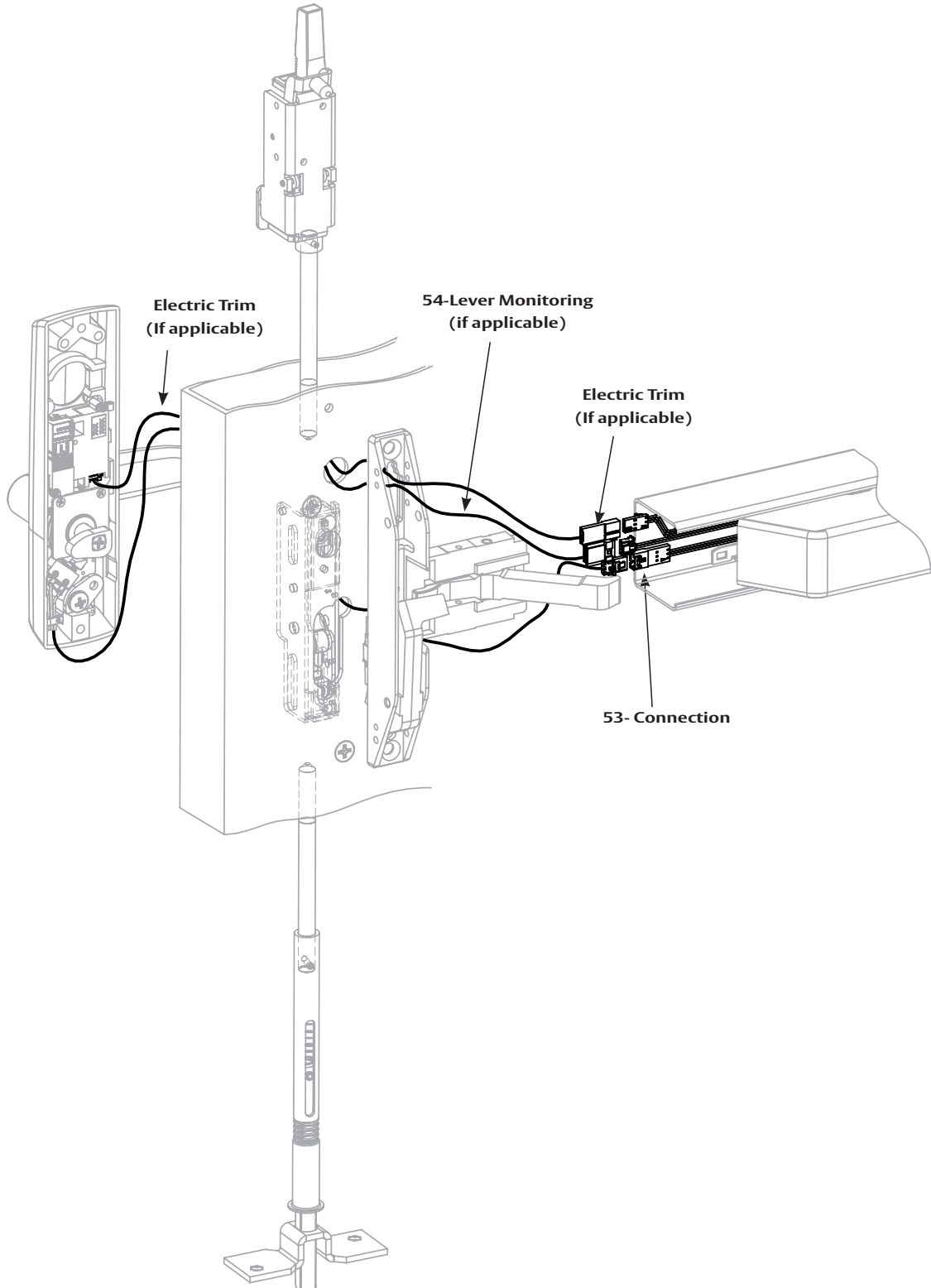

## 5

## Wire Routing - continued

8400

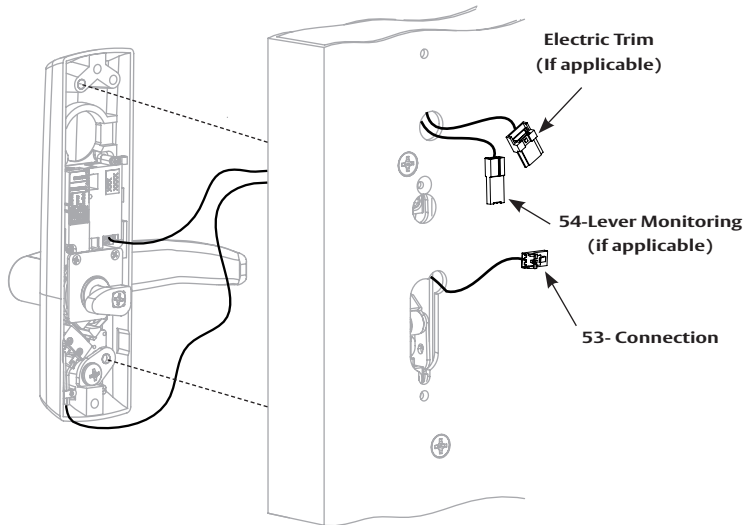

Step 1. Route wires as shown and secure trim to door.

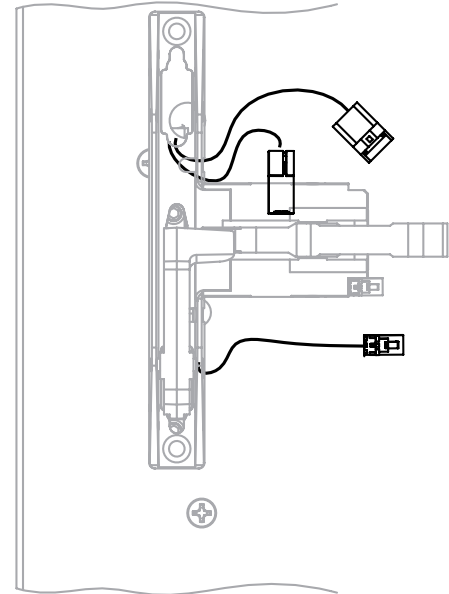

Step 2. Route wires through chassis as shown and secure chassis to door.

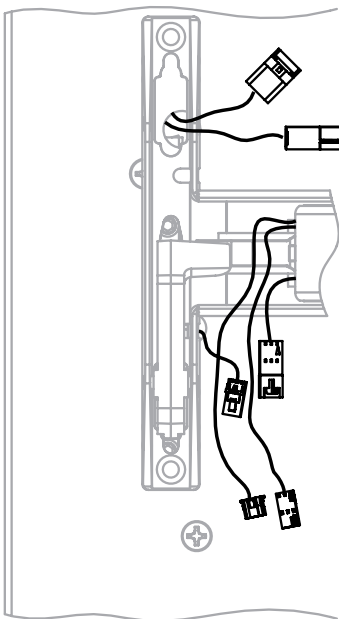

Step 3. Install rail.

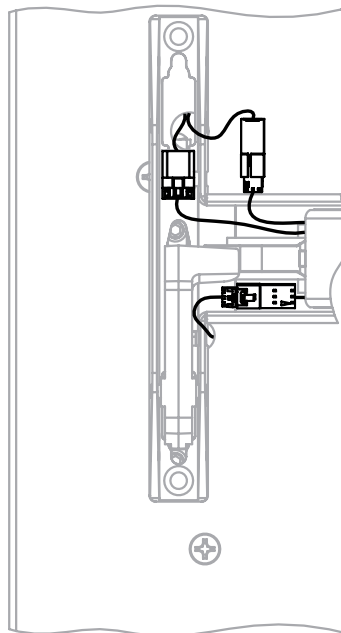

Step 4. Make wire connections.

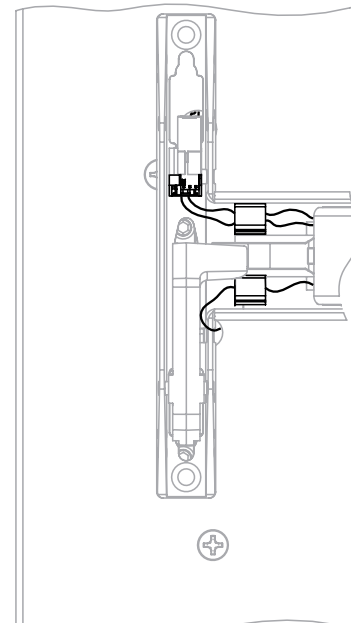

Step 5. Pull back excess wire through rail. Route wires as shown. Install wire clips.

### 5

### Wire Routing - continued

#### 8500 OVERVIEW

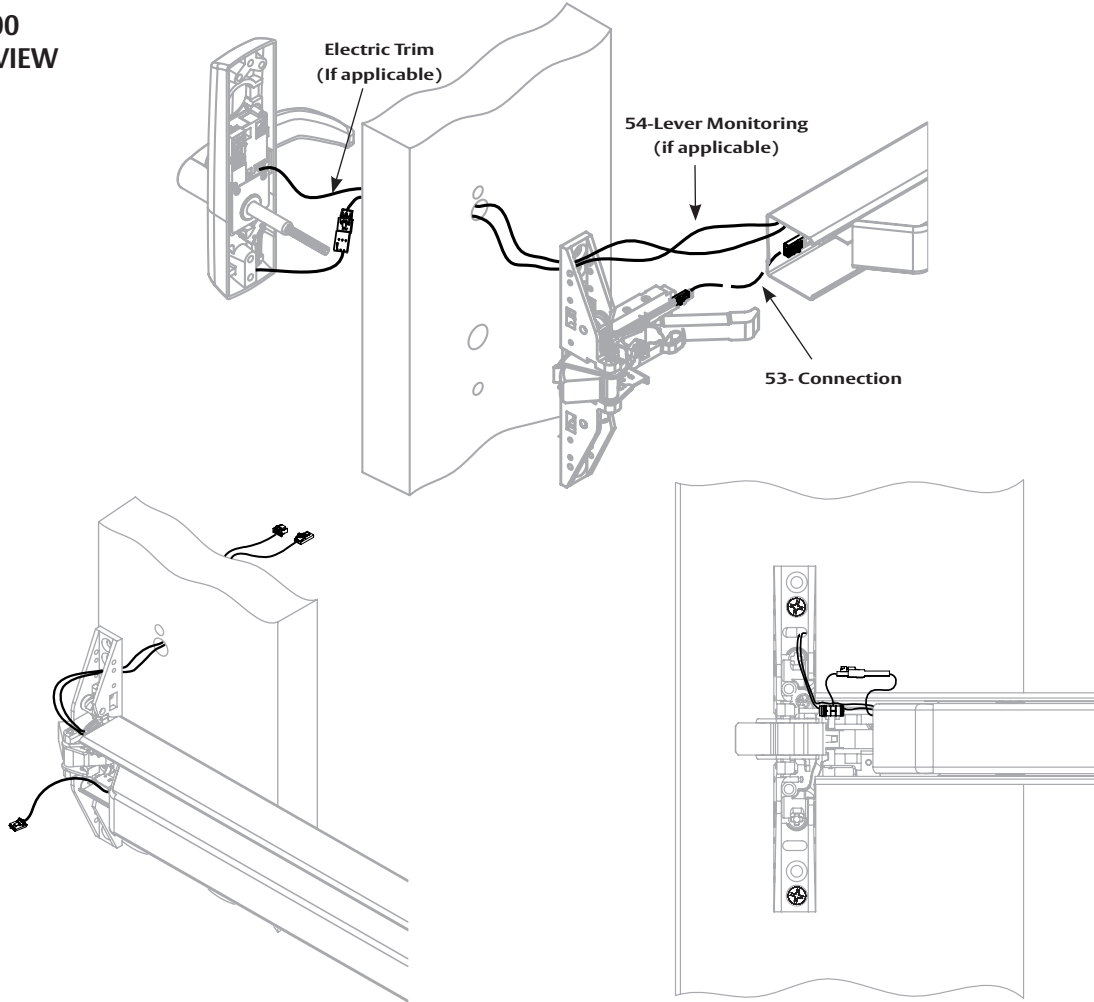

**Step 1. Install chassis to rail.**  
Route wires through door as shown.

**Step 2. Secure trim. Make 53- connection.**

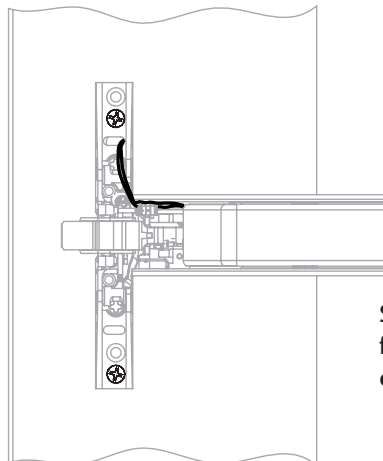

**Step 3. Pull additional wire slack through rail from insert end and tuck latch bolt monitor (53-) connection into chassis.**



## 5

## Wire Routing - continued

### 8600 OVERVIEW

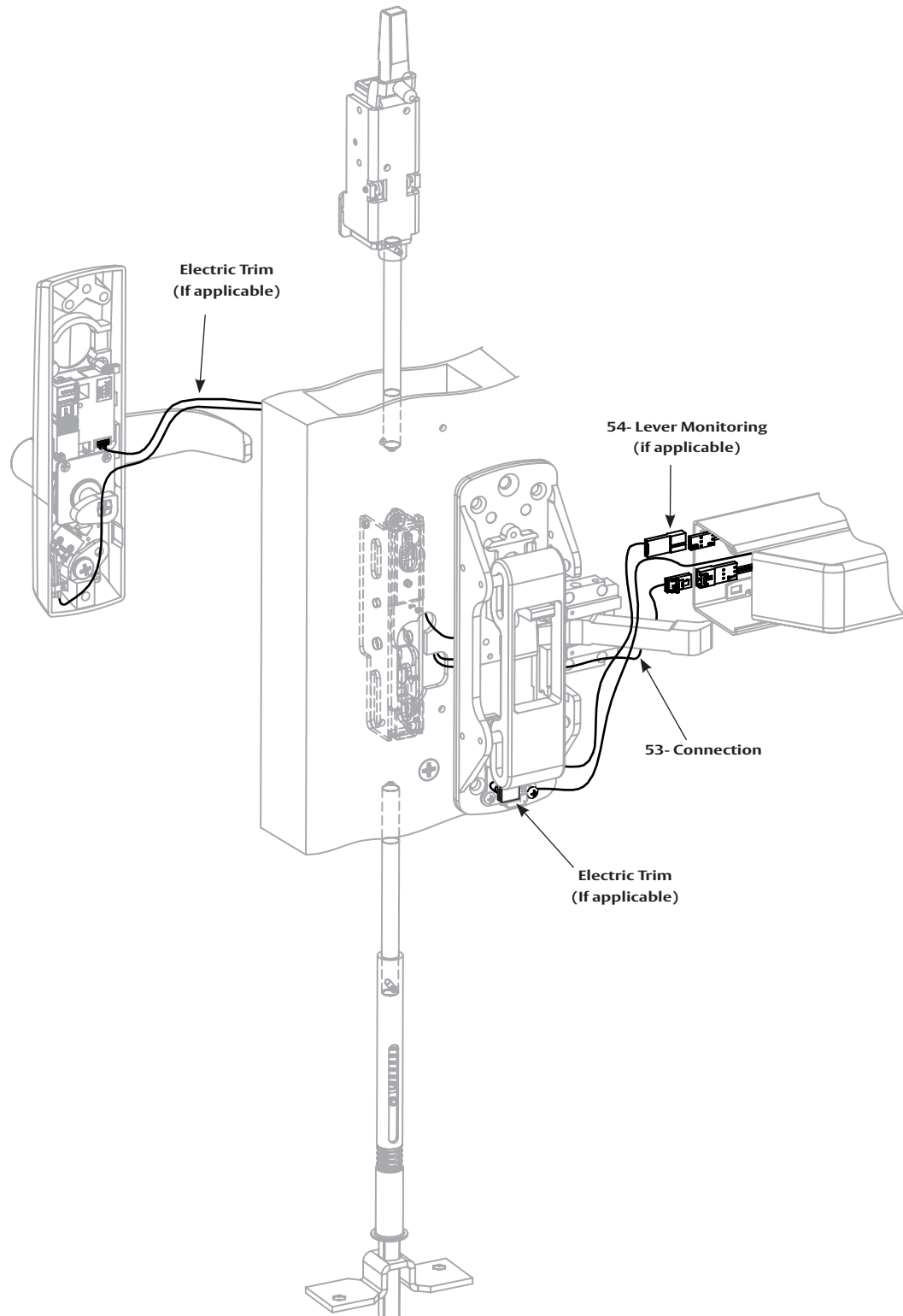

### 5

### Wire Routing - continued

8600

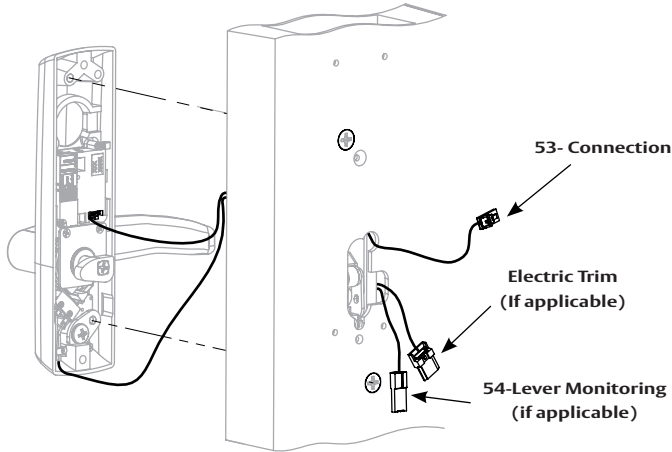

Step 1. Route wires as shown and secure trim to door.

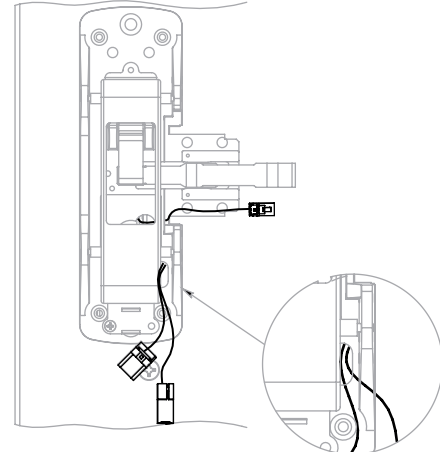

Step 2. Install chassis (Section 4) and route wires through chassis as shown.

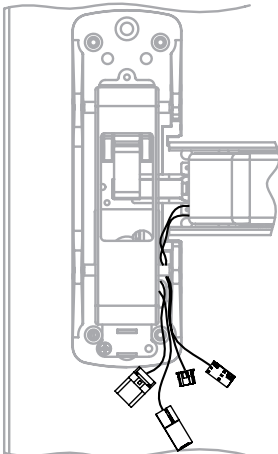

Step 3. Install rail.

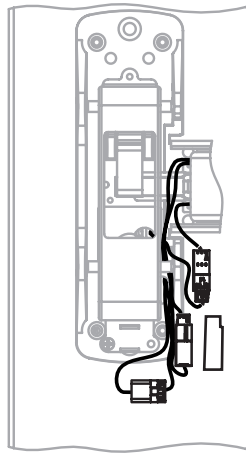

Step 4. Make wire connections.

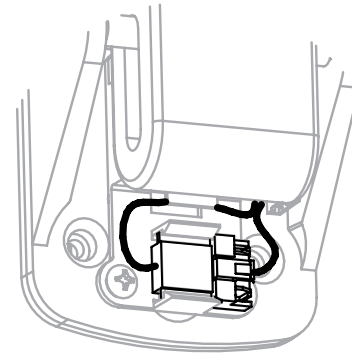

Step 5. Snap trim jumper to clip and route excess wire as shown.

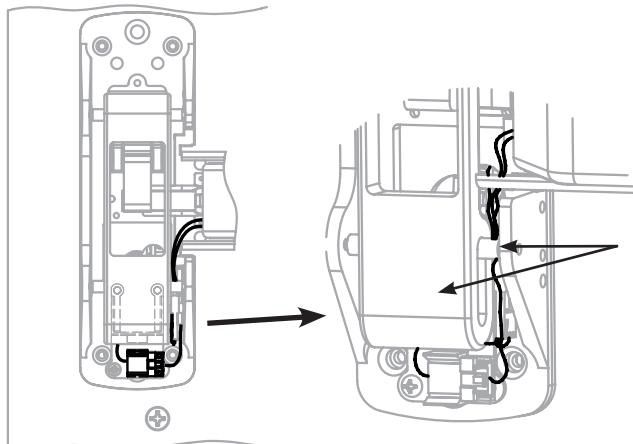

Main Slide & Roller

Step 6. Tuck wire connections along side of main slide. Pull back excess wire through rail.

# PE80 Series Exit Devices

## Electrified Exit Options

### Installation Instructions

**SARGENT**

**ASSA ABLOY**

5

## Wire Routing - continued

### 8700 OVERVIEW

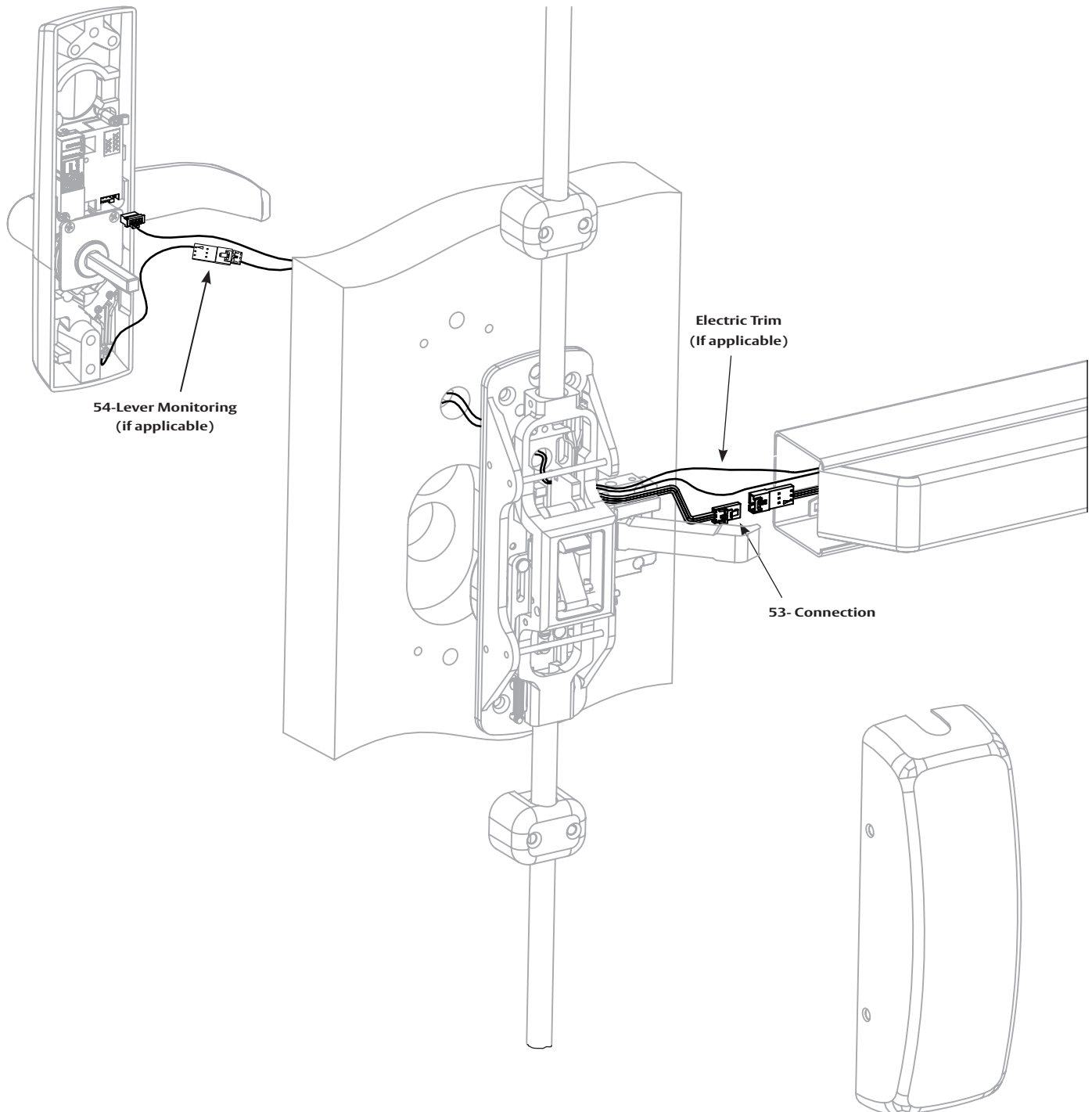

5

## Wire Routing - continued

8700

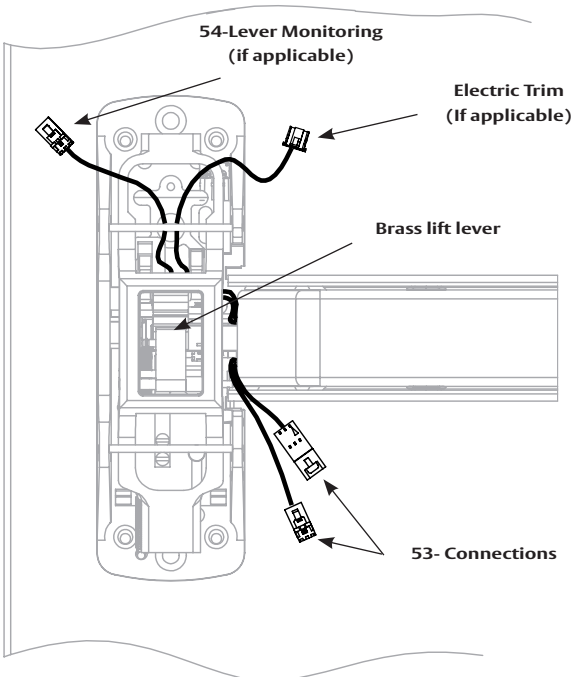

**Step 1. Install chassis and rail. Route trim wires from rail under brass lift lever as shown.**

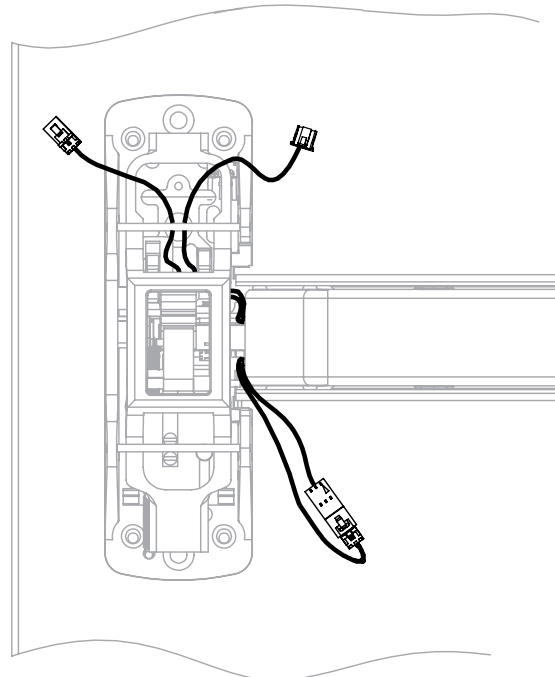

**Step 2. Make 53-connection.**

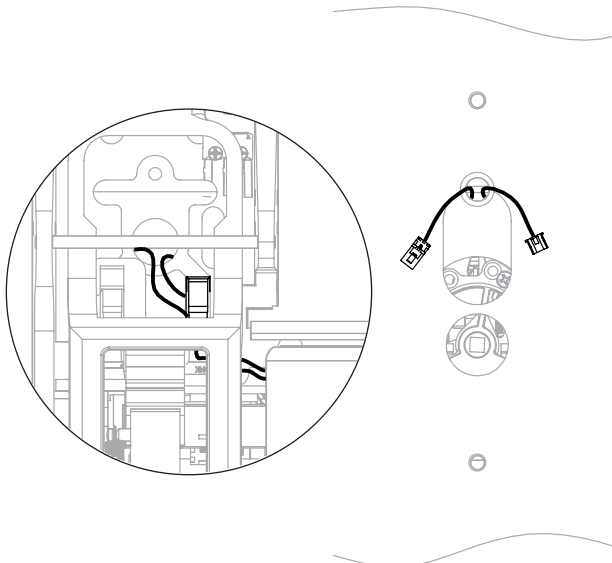

**Step 3. Route trim wires through chassis and door as shown.**

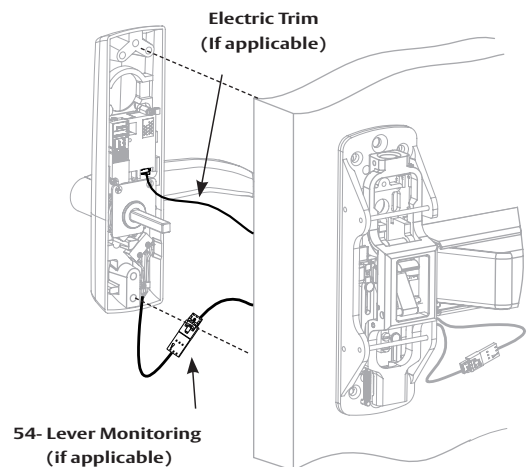

**Step 4. Make trim wire connections and secure trim to door. Pull back excess wire through rail.**

## 5

## Wire Routing - continued

### 8800 OVERVIEW

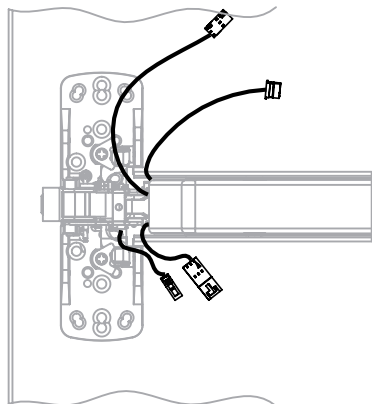
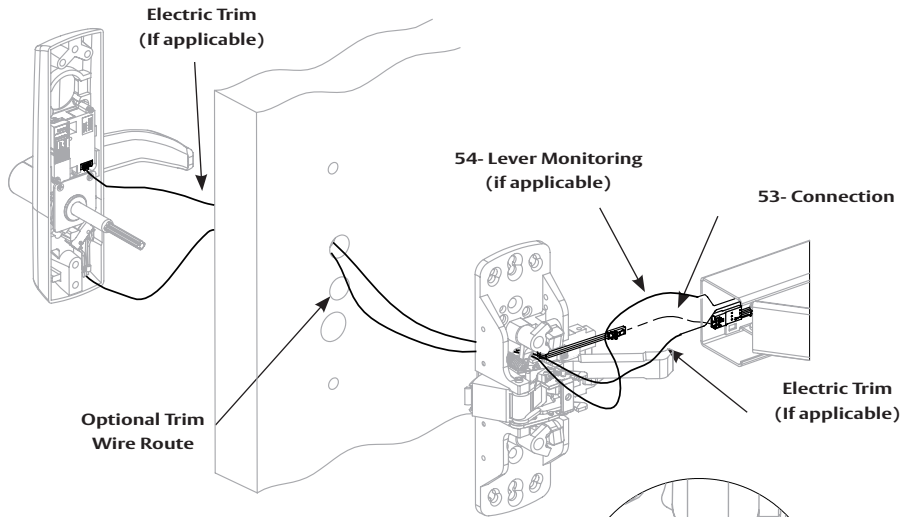

Step 1. Install chassis and rail.

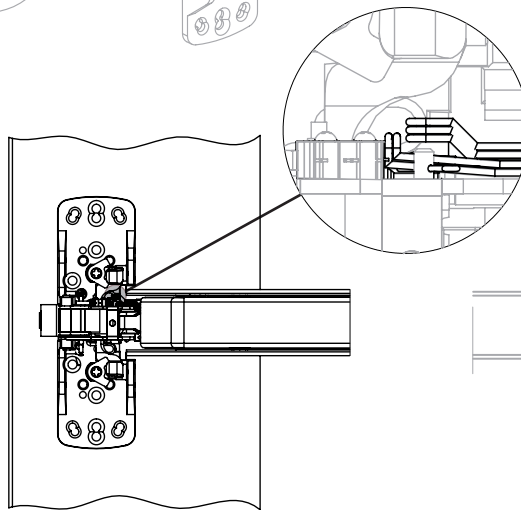

Step 2. Route trim wires through chassis and door as shown above.

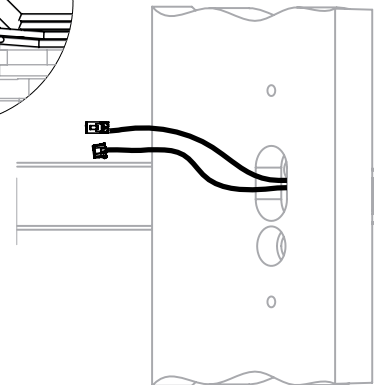

Step 2A. Additional view

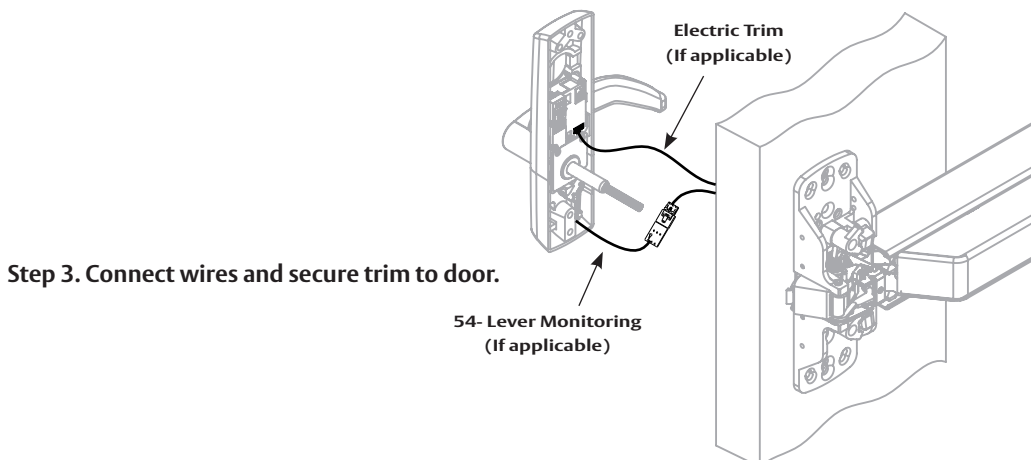

Step 3. Connect wires and secure trim to door.

#### 5

### Wire Routing - continued

#### 8900 OVERVIEW

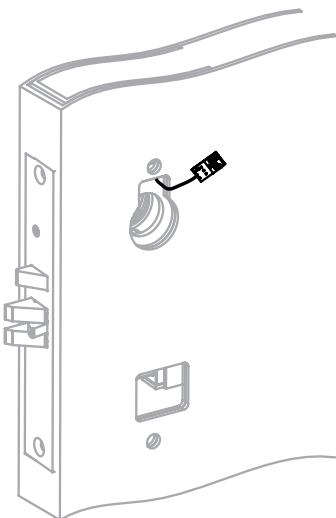
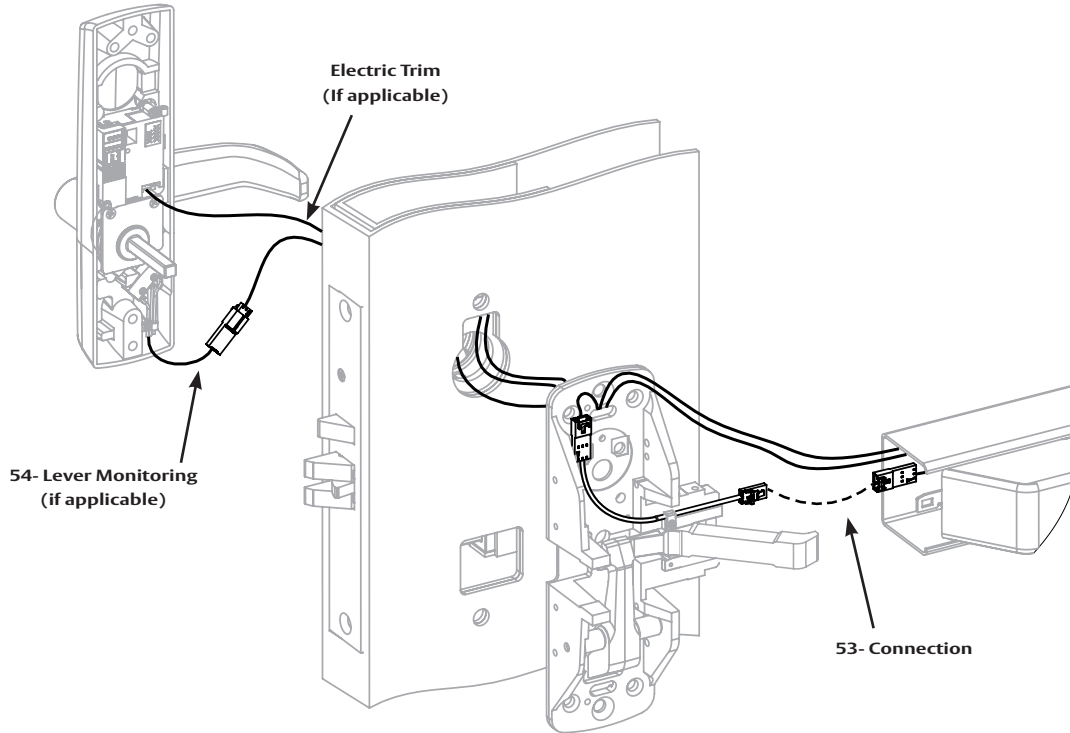

**Step 1. Install mortise lock. Route wire as shown.**

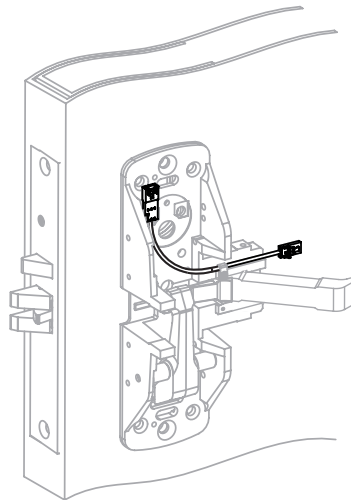

**Step 2. Install chassis and connect 53-jumper at chassis.**

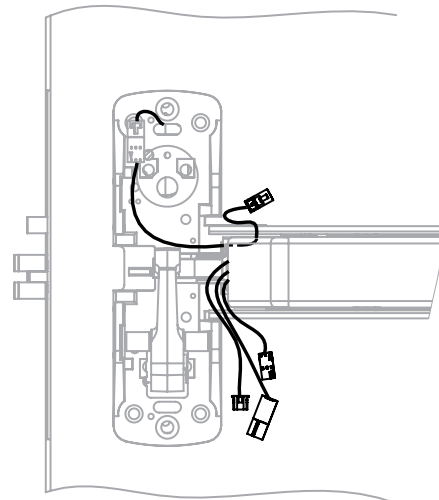

**Step 3. Install rail to chassis.**

8900

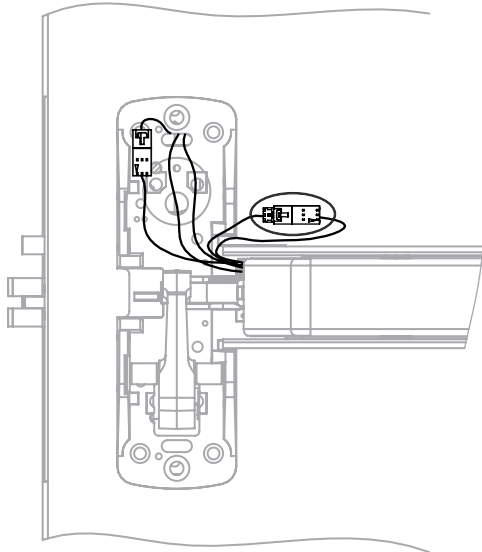

Step 4. Make wire connections.

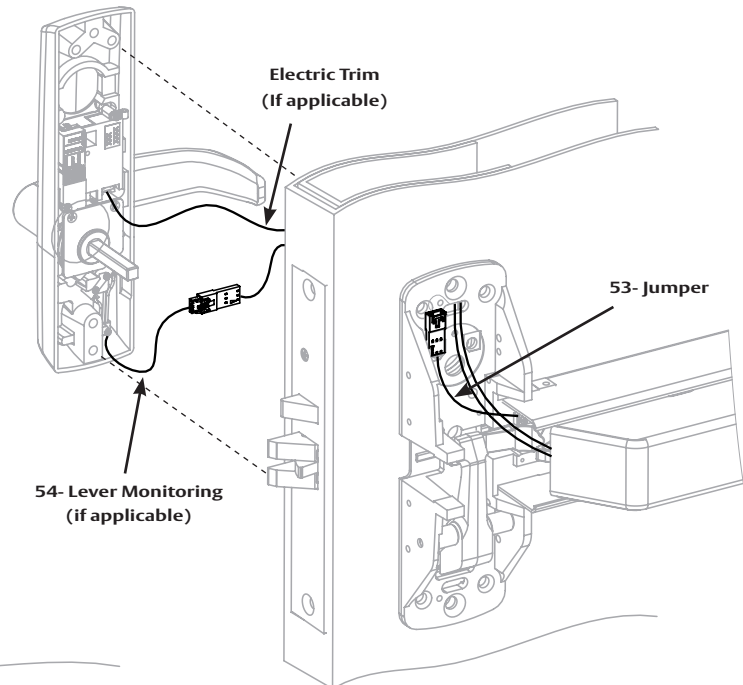

Step 5. Secure trim to door.

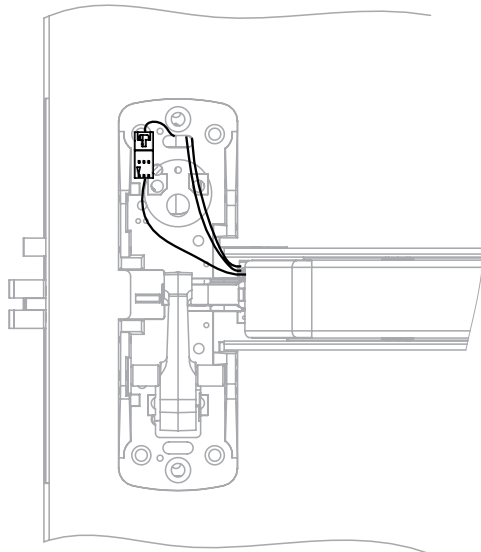

Step 6. Pull back excess wire through rail.

**6**

**PE80 Series Installation and Wiring Overview**

**ElectroLynx System Wiring Options  
QC12 Hinge (12 wires)  
Pluggable 8-pin & 4-pin connectors**

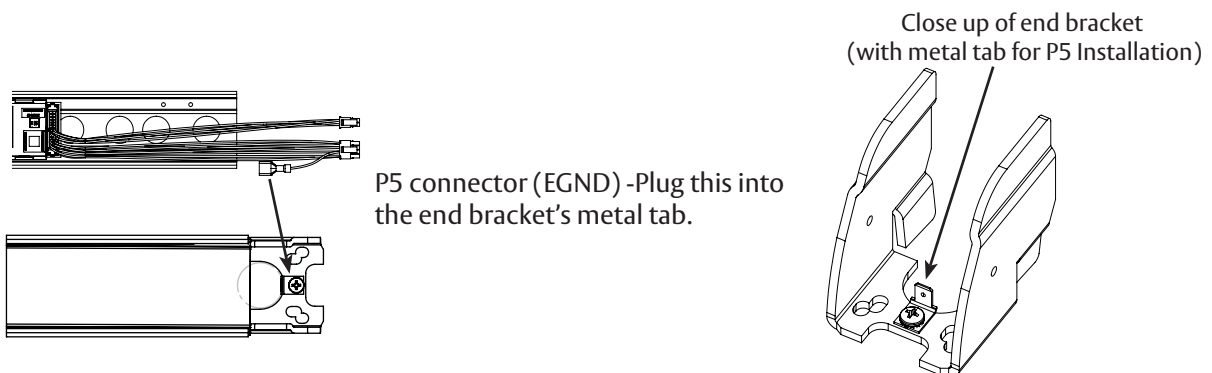
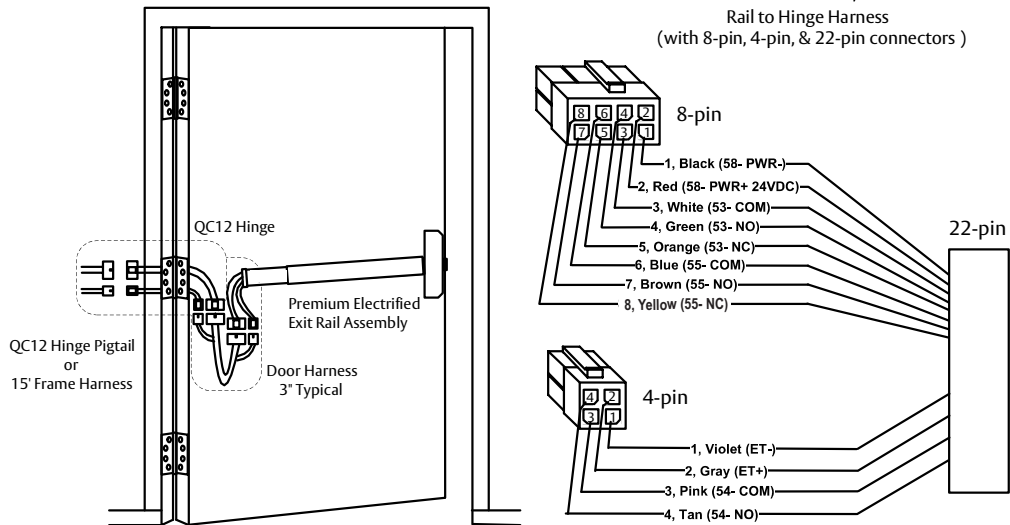
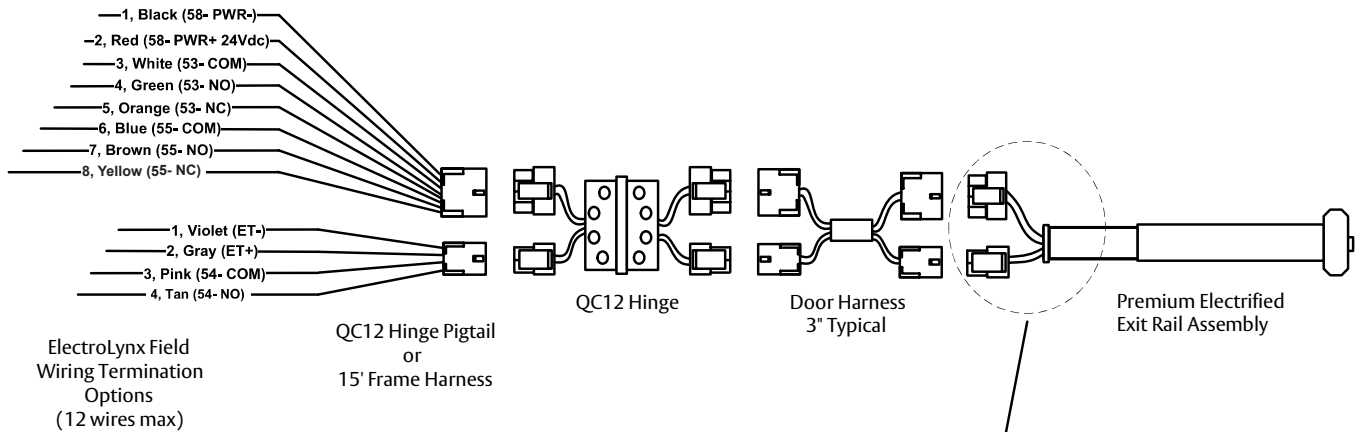



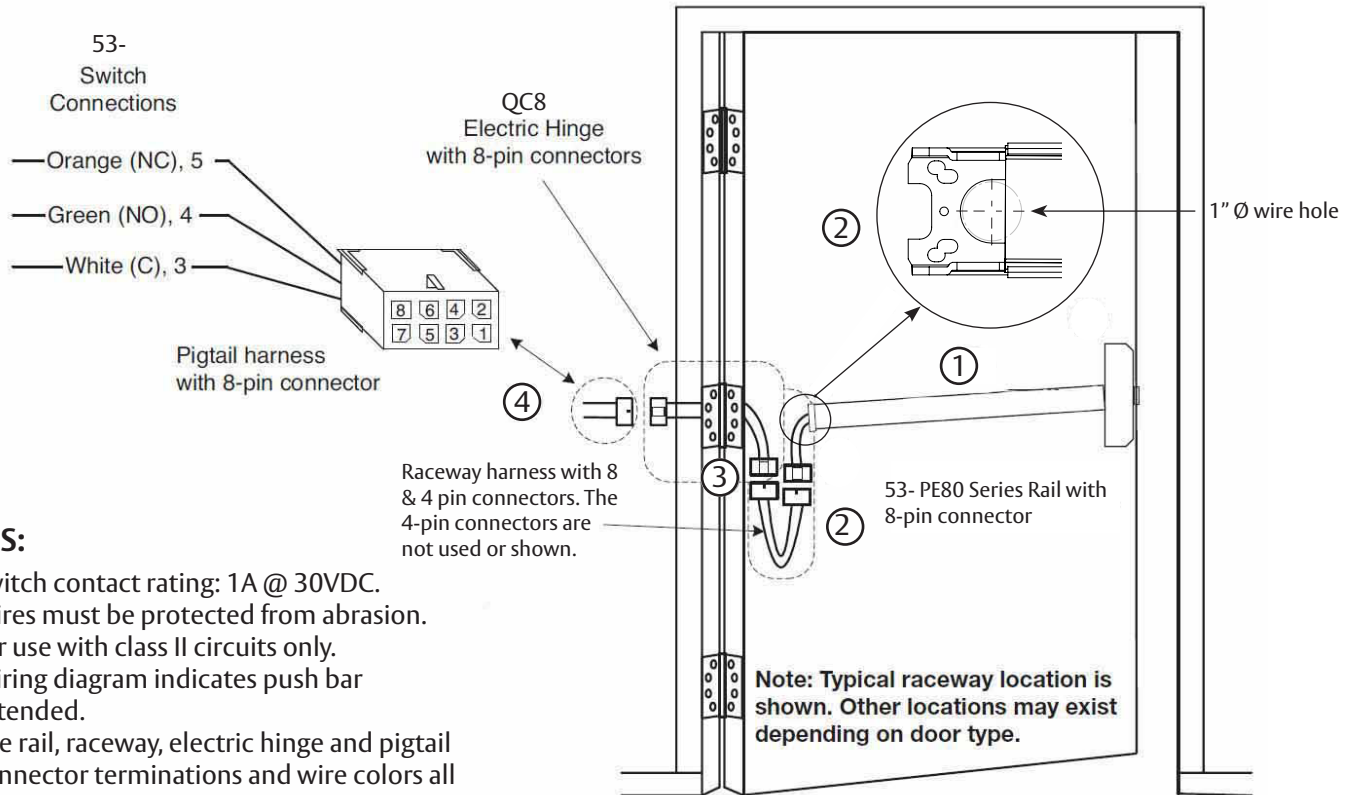

#### NOTES:

- Switch contact rating: 1A @ 30VDC.
- Wires must be protected from abrasion.
- For use with class II circuits only.
- Wiring diagram indicates push bar extended.
- The rail, raceway, electric hinge and pigtail connector terminations and wire colors all match.

#### Installation Instructions:

- ① Mount exit device per instruction sheet provided.

To insure trouble free operation, check that the push rail can be fully depressed. On vertical rod exit devices, check that the latch bolts do not go into hold back position until the push rail is fully depressed.

- ② Plug rail connector into raceway connector. Then feed through 1" hole in door. Install rail mounting bracket with two screws supplied. Install rail insert and end cap.
- ③ Plug raceway connector into electric hinge connector, then feed through door prep. Mount electric hinge to door.
- ④ Go to (A) if wiring now. Go to (B) if wiring is to be done later.
  - (A) Wire frame side wires to wires on pigtail harness as required using connectors allowed by local code. Plug pigtail harness connector into electric hinge connector. Feed harnesses through frame prep and mount electric hinge.
  - (B) Plug pigtail harness connector into electric hinge connector. Feed harnesses through frame prep and mount electric hinge.

#### NOTES:

- Switch contact rating: 1A @ 30VDC.
- Wires must be protected from abrasion.
- For use with class II circuits only.
- Wiring diagram indicates push bar extended.
- Rail, raceway, electric hinge and pigtail connector terminations and wire colors all match.

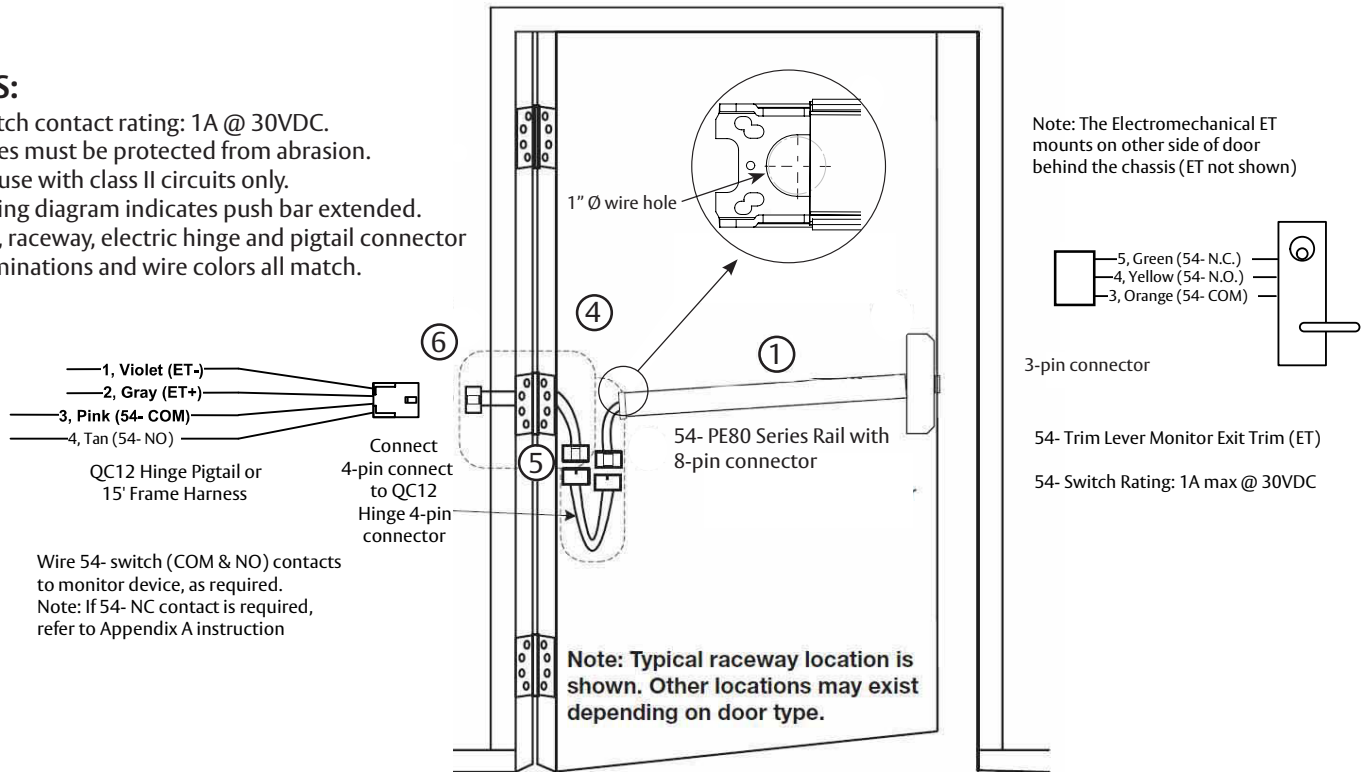

#### Installation Instructions:

- ① Mount exit device per instruction sheet provided.
2. From outside of door, route Electromechanical ET wire harness through chassis and door, then plug 3-pin connector into mating rail harness 3-pin connector.
3. Ensure wires are tucked in to avoid pinching wires by push bar or chassis mechanism.
- ④ Plug rail connector into raceway connector. Then feed through 1" hole in door. Install rail mounting bracket with two screws supplied. Install rail insert and end cap.
- ⑤ Plug raceway connector into electric hinge connector, then feed through door prep. Mount electric hinge to door.
- ⑥ Go to (A) if wiring now. Go to (B) if wiring is to be done later:
  - (A) Wire frame side wires to wires on pigtail harness as required using connectors allowed by local code. Plug pigtail harness connector into electric hinge connector. Feed harnesses through frame prep and mount electric hinge.
  - (B) Plug pigtail harness connector into electric hinge connector. Feed harnesses through frame prep and mount electric hinge.
7. Test lock – 54-trim lever monitor switch monitors lever movement. Switch changes state when lever is rotated.

### 55- PE80 Series (Signal Switch) Installation and Wiring

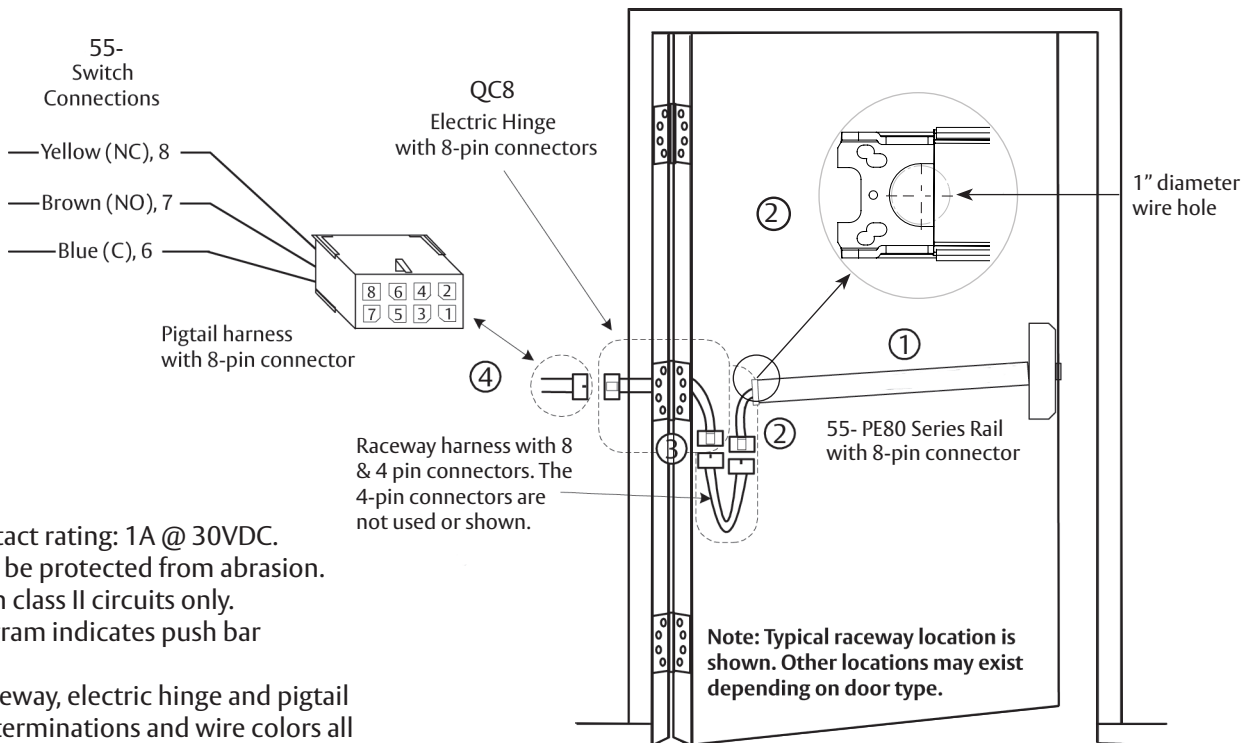

#### NOTES:

- Switch contact rating: 1A @ 30VDC.
- Wires must be protected from abrasion.
- For use with class II circuits only.
- Wiring diagram indicates push bar extended.
- The rail, raceway, electric hinge and pigtail connector terminations and wire colors all match.

#### Installation Instructions:

- ① Mount exit device per instruction sheet provided.

To insure trouble free operation, check that the push rail can be fully depressed. On vertical rod exit devices, check that the latch bolts do not go into hold back position until the push rail is fully depressed.

- ② Plug rail connector into raceway connector. Then feed through 1" hole in door. Install rail mounting bracket with two screws supplied. Install rail insert and end cap.
- ③ Plug raceway connector into electric hinge connector, then feed through door prep. Mount electric hinge to door.
- ④ Go to (A) if wiring now. Go to (B) if wiring is to be done later.
  - (A) Wire frame side wires to wires on pigtail harness as required using connectors allowed by local code. Plug pigtail harness connector into electric hinge connector. Feed harnesses through frame prep and mount electric hinge.
  - (B) Plug pigtail harness connector into electric hinge connector. Feed harnesses through frame prep and mount electric hinge.

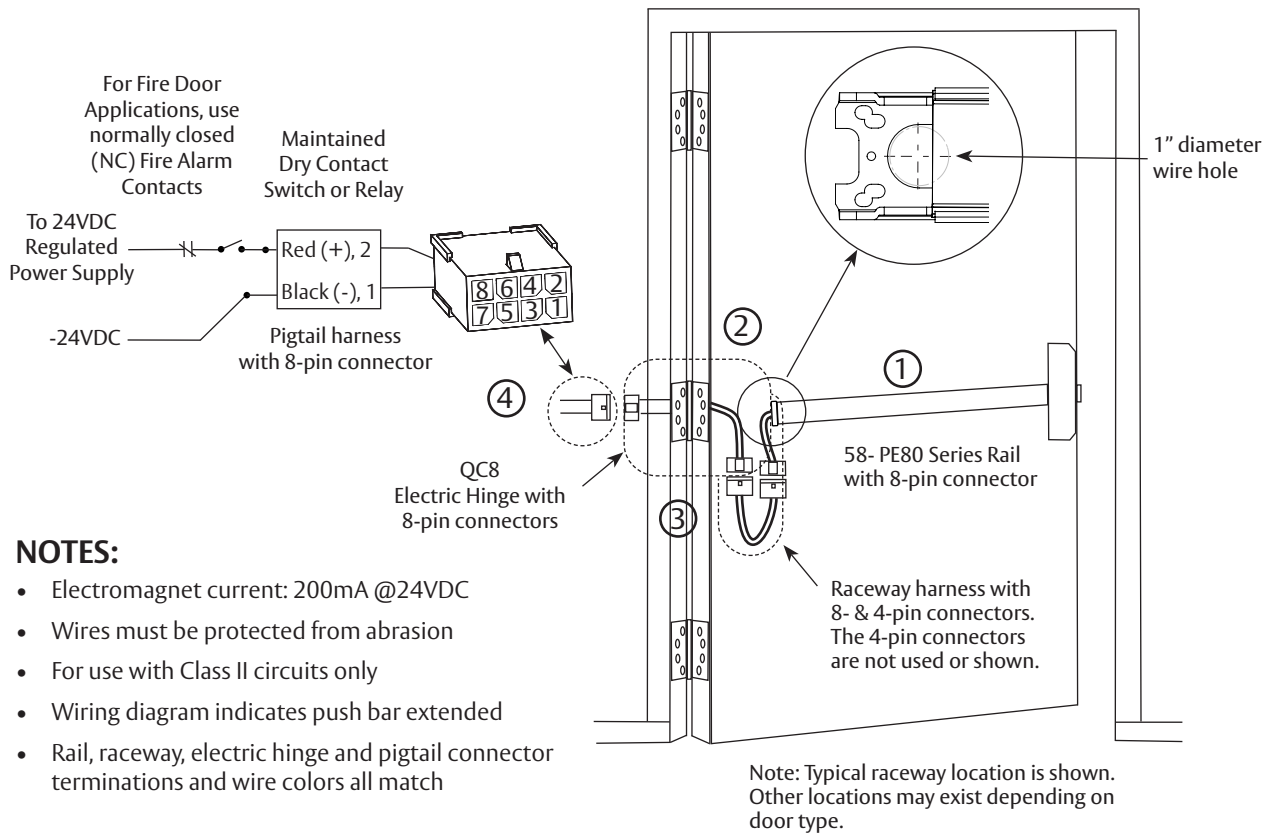

**Installation Instructions:**

① Mount exit device per instruction sheet provided.

**To insure trouble free operation, check that the push rail can be fully depressed. On vertical rod exit devices, check that the latch bolts do not go into hold back position until the push rail is fully depressed.**

② Plug rail connector into raceway connector. Then feed through 1" hole in door. Install rail mounting bracket with two screws supplied. Install rail insert and end cap.

③ Plug raceway connector into electric hinge connector, then feed through door prep. Mount electric hinge to door.

④ Go to (A) if wiring now. Go to (B) if wiring is to be done later.

(A) Wire frame side wires to wires on pigtail harness as required using connectors allowed by local code. Plug pigtail harness connector into electric hinge connector. Feed harnesses through frame prep and mount electric hinge.

(B) Plug pigtail harness connector into electric hinge connector. Feed harnesses through frame prep and mount electric hinge.

### 11

### P/PW773, P/PW774, P/PW775, P/PW776 (Electromechanical Exit Trim) - Exit Device to Frame Connection

1. Mount exit device per instruction sheet provided.
2. From outside of door, route Electromechanical ET wire harness through chassis, then plug 2-pin connector into mating rail harness 2-pin connector. Ensure wires are tucked in to avoid pinching wires by push bar or chassis mechanism.
3. Wire to the QC12 Hinge pigtail harness 4-pin connector.
4. Ensure proper voltage is being applied to pigtail harness.
5. Plug pigtail harness 4-pin connector into QC12 hinge 4-pin connector.



**Caution:** The DC voltage applied must not exceed 30VDC. If the applied voltage exceeds 30VDC, the electromechanical trim motor may be damaged.

6. Test lock – Fail Secure unlocks with 24VDC power applied. Fail Safe locks with 24VDC power applied.

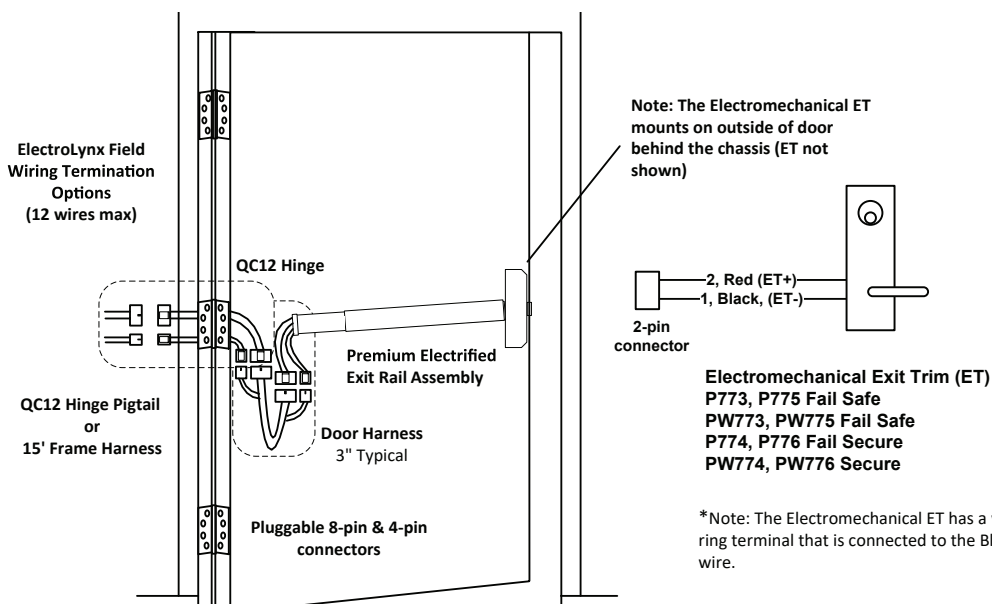
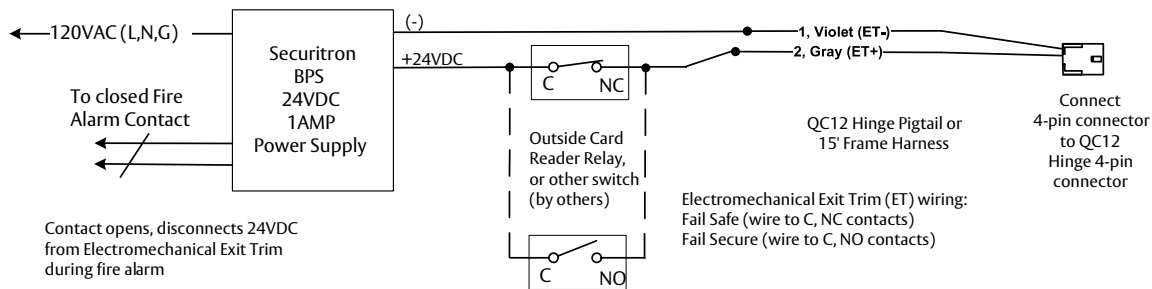

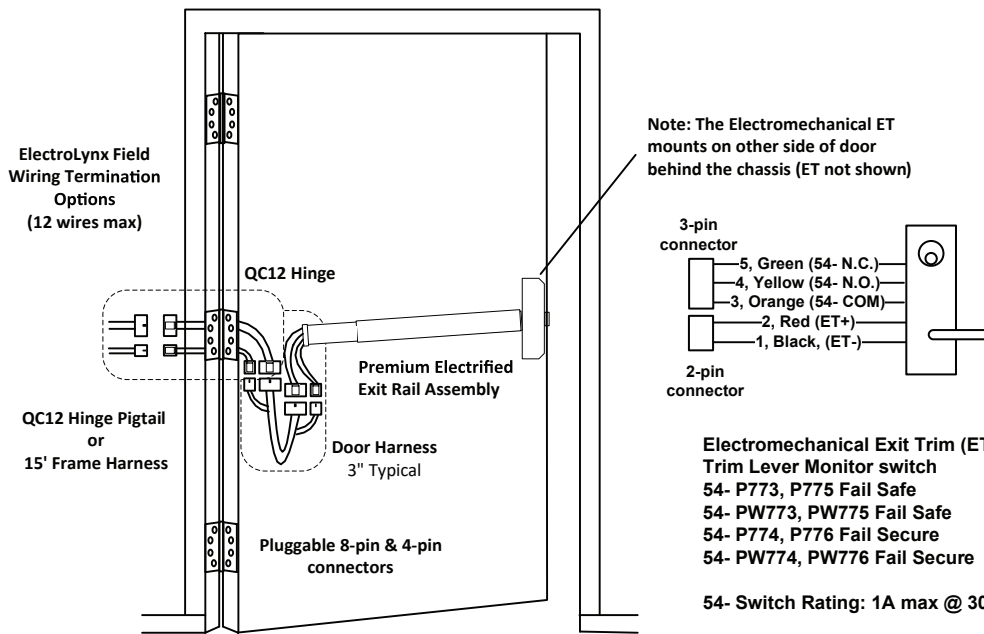
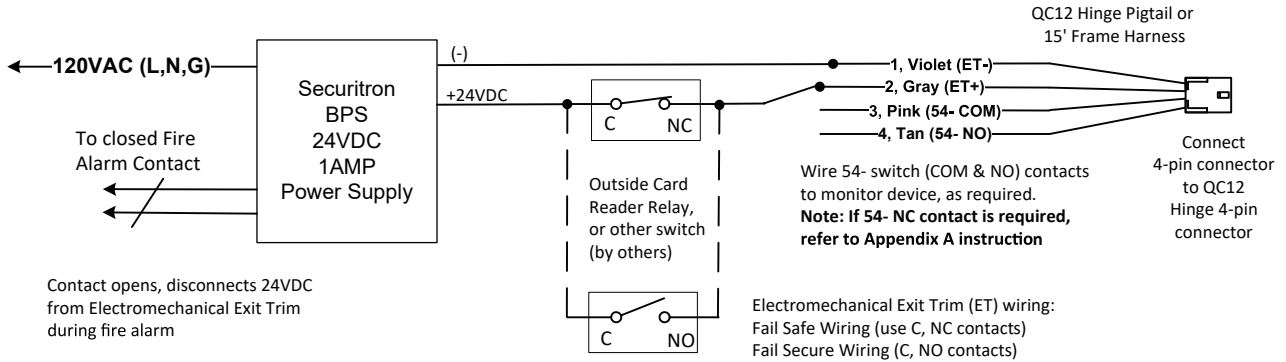

**Electromechanical Exit Trim (ET) with 54-Trim Lever Monitor switch**  
**54- P773, P775 Fail Safe**  
**54- PW773, PW775 Fail Safe**  
**54- P774, P776 Fail Secure**  
**54- PW774, PW776 Fail Secure**

**54- Switch Rating: 1A max @ 30VDC**

\*Note: The Electromechanical ET has a wire that ring that is connected to black ET- wire.

## 12

## Appendix A: Harness Wiring Reconfiguration

### Premium Electrical Exits (NO PCBA)

#### Rail to QC12 Hinge Side Harness

22-pin connector to 8 & 4-pin ELynx connectors

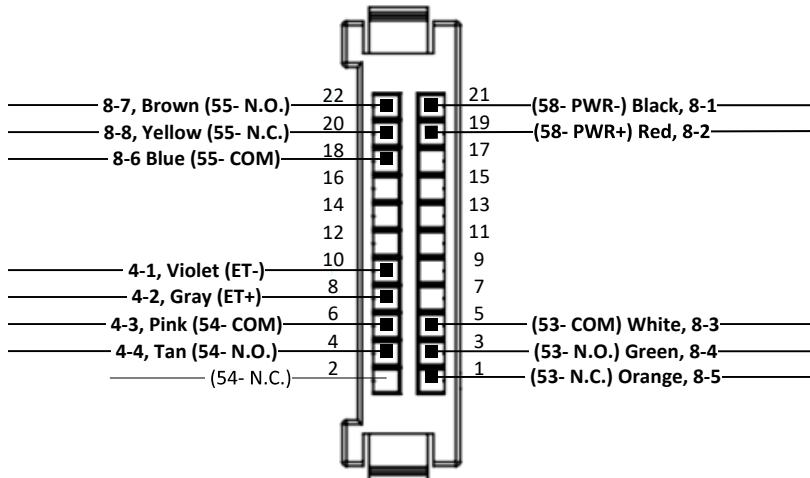

12 + 1 = 13 total wiring selections

#### LEGEND – Premium Exits Electrical Options, NO PCBA

- 53- Latch Monitor Switch (Form C) in Chassis, remote monitor, etc.
- 55- Push Bar Switch (Form C) – REX, de-energize external magnet, remote monitor, etc.
- 58- Electric Dogging (magnet in rail) - manually press push bar to dog rail when powered
  
- ET Electrified Exit Trim (Ecoflex motor 10 to 30VDC)
- 54- ET Lever Monitor Switch (Form C)

### Premium Electrical Exits (NO PCBA)

#### ElectroLynx QC12

#### Factory Default Ship Configuration

22-21	58- PWR-	Black	8-1
22-19	58- PWR+ (24VDC)	Red	8-2
22-5	53- COM	White	8-3
22-3	53- N.O.	Green	8-4
22-1	53- N.C.	Orange	8-5
22-18	55- COM	Blue	8-6
22-22	55- N.O.	Brown	8-7
22-20	55- N.C.	Yellow	8-8
22-10	ET-	Violet	4-1
22-8	ET+	Gray	4-2
22-6	54- COM	Pink	4-3
22-4	54- N.O.	Tan	4-4
22-2	54- N.C.	No wire	

The factory ships the rail to hinge side harness with 12 default wires terminated from the 22-pin connector to 8-pin & 4-pin connectors.

There are a total of 13 wiring choices (with 1 additional wiring choice):

- 54- N.C.

#### Wire reconfiguration:

1. Remove exit device end cap.
2. Slide the metal insert cover off of rail.
3. Unplug the harness 22-pin connector from mating rail harness 22-pin connector.

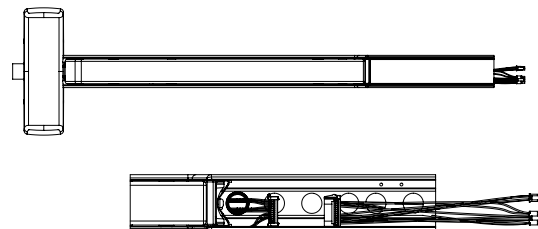

Follow correct Horizontal Insertion view when inserting crimped terminal/wire into socket (26-pin connector), as shown below. For re-pinning, please contact technical service at 1-800-727-5477.

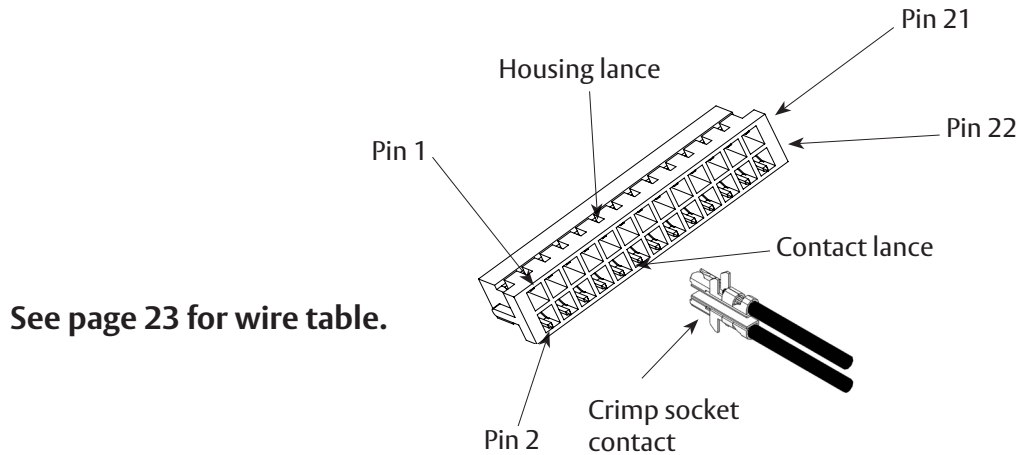

**If the 54- NC (22-2) contact is required instead of 54- NO (22-4, Tan wire):**

Remove crimped contact/tan wire assembly from 22 pin connector position 4 (22-4), using pointed tool to lift up plastic locking housing lance on connector, then slowly and carefully remove the contact/tan wire assembly from connector by hand.

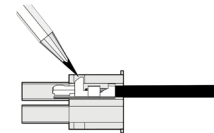

Insert crimped contact/wire assembly into new connector position 22-2 (54- NC). Be sure to follow correct Horizontal Insertion view when inserting crimped terminal/wire into socket (22-pin connector), as shown. Plug in 22-pin mating harness connectors, re-install rail metal insert cover, complete hinge side facility wiring, then re-install end cap.

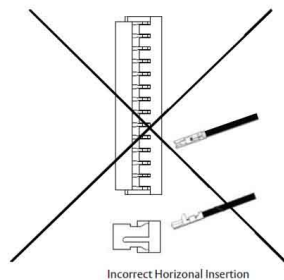
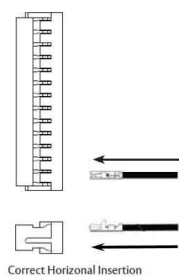

**Do not tilt crimped terminals during insertion.**









The ASSA ABLOY Group is the global leader in access solutions. Every day, we help billions of people experience a more open world.

ASSA ABLOY Opening Solutions leads the development within door openings and products for access solutions in homes, businesses and institutions. Our offering includes doors, frames, door and window hardware, mechanical and smart locks, access control and service.

**SARGENT**  
**ASSA ABLOY**

SARGENT Manufacturing  
100 Sargent Drive  
New Haven, CT 06511 USA  
800-810-9473 • [www.sargentlock.com](http://www.sargentlock.com)

Copyright © 2023 Sargent Manufacturing Company, an ASSA ABLOY Group company. All rights reserved.  
Reproduction in whole or in part without the express written permission of Sargent Manufacturing Company is prohibited. Patent pending and/or patent - [www.assaabloydss.com/patents](http://www.assaabloydss.com/patents).  
HID, iCLASS, and Edge are trademarks or registered trademarks of HID Global Corporation.

A8299-1 - 05/23