

Cylinder Dogging

PE80 Series Exit Devices

Cylinder Insert View

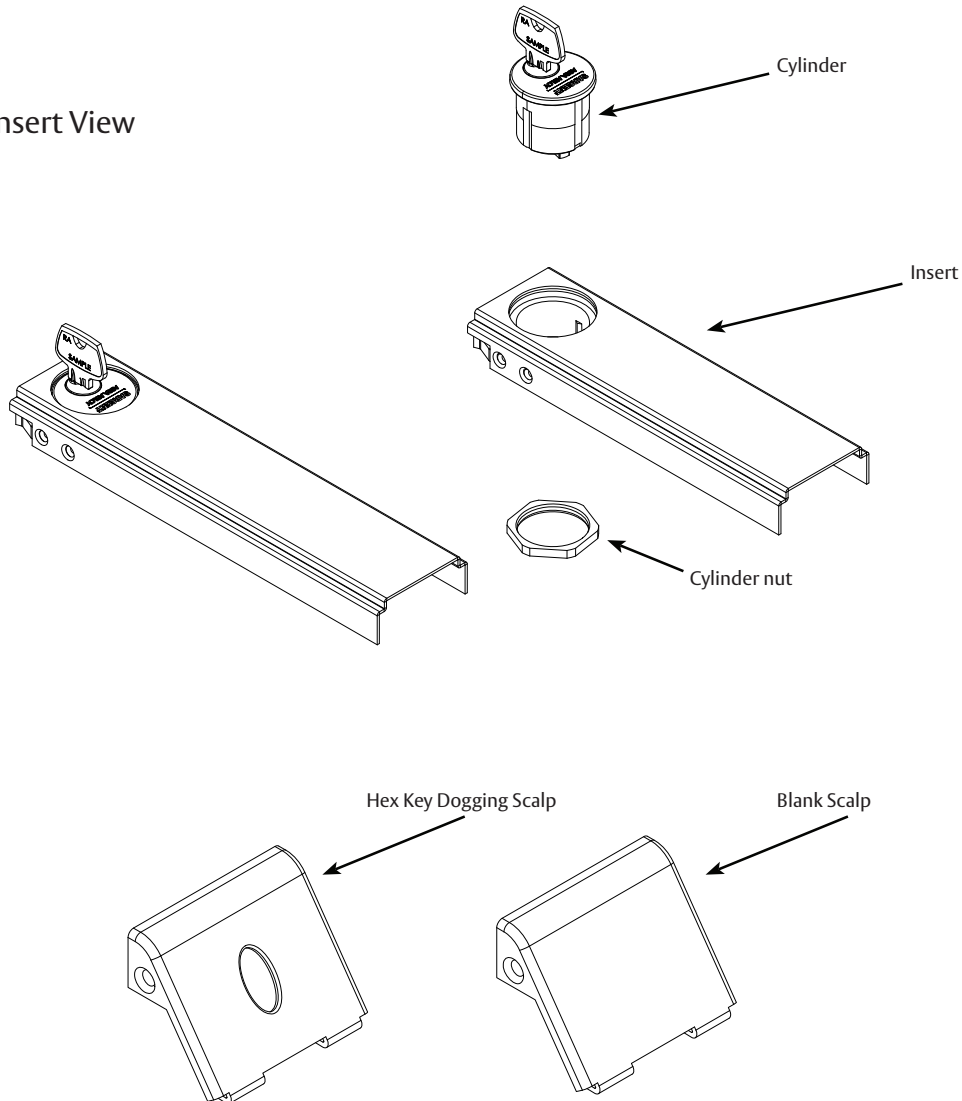

⚠ WARNING

This product can expose you to lead which is known to the state of California to cause cancer and birth defects or other reproductive harm. For more information go to www.P65warnings.ca.gov.

⚠ WARNING

Attention Installer: Improper installation may result in damage to the product and void the factory warranty.

Cylinder Dogging

PE80 Series Exit Devices

Installation Instructions

SARGENT

ASSA ABLOY

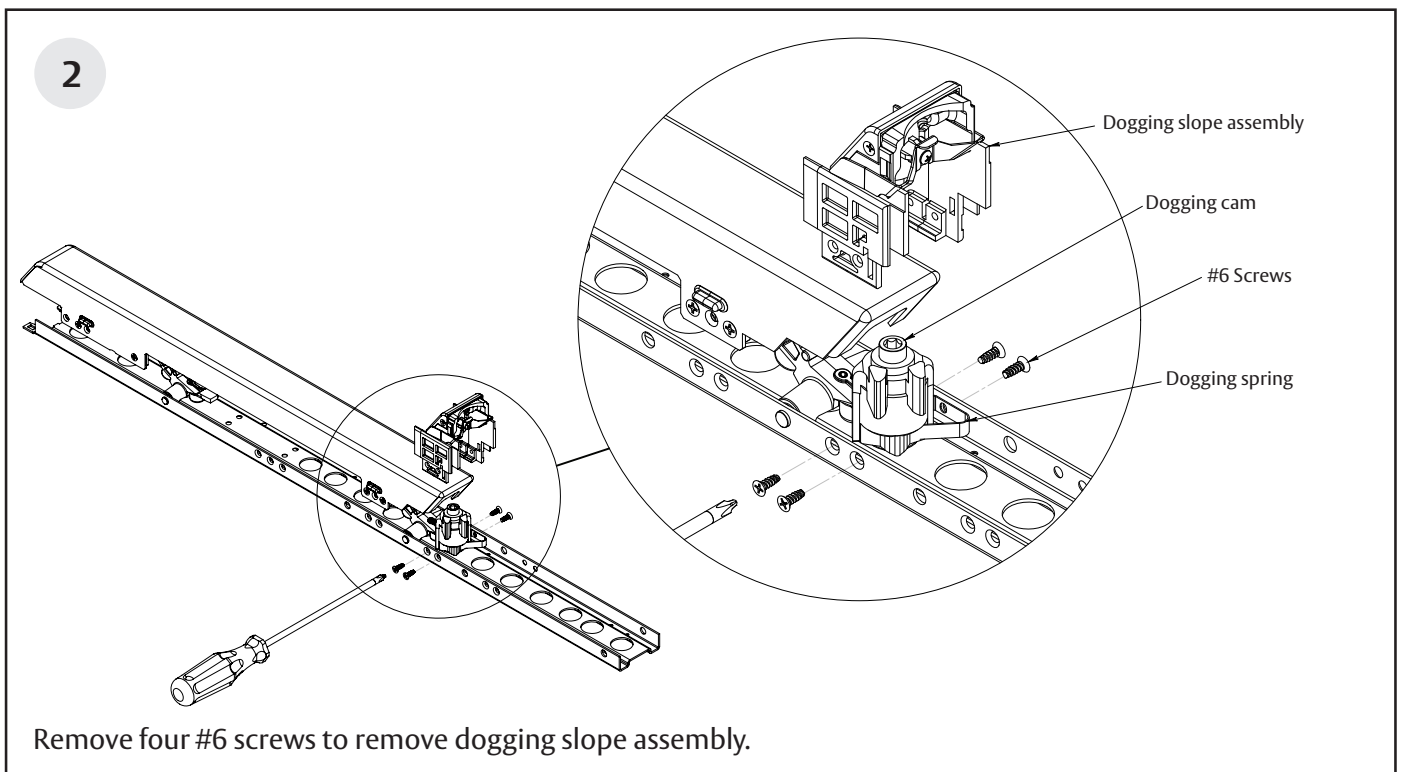
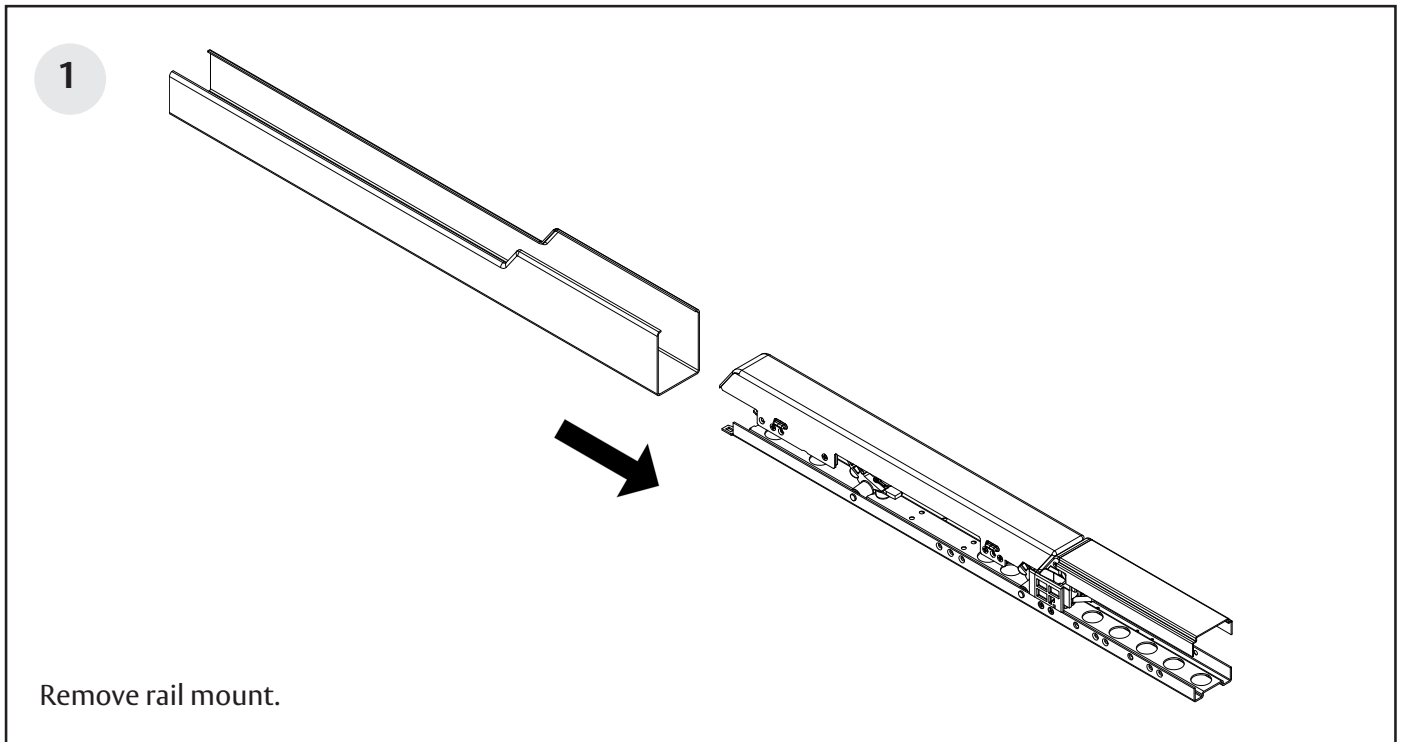

Cylinder Dogging

PE80 Series Exit Devices

Installation Instructions

SARGENT

ASSA ABLOY

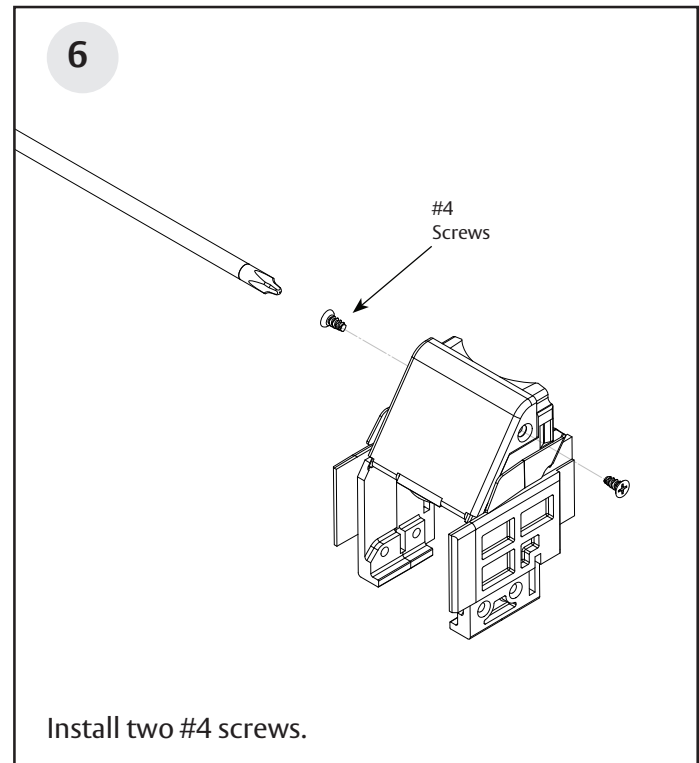
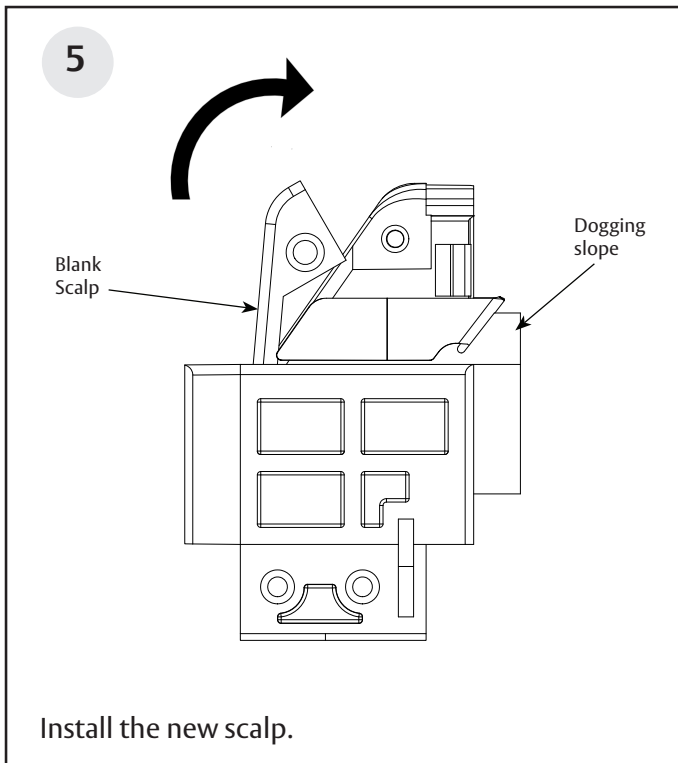
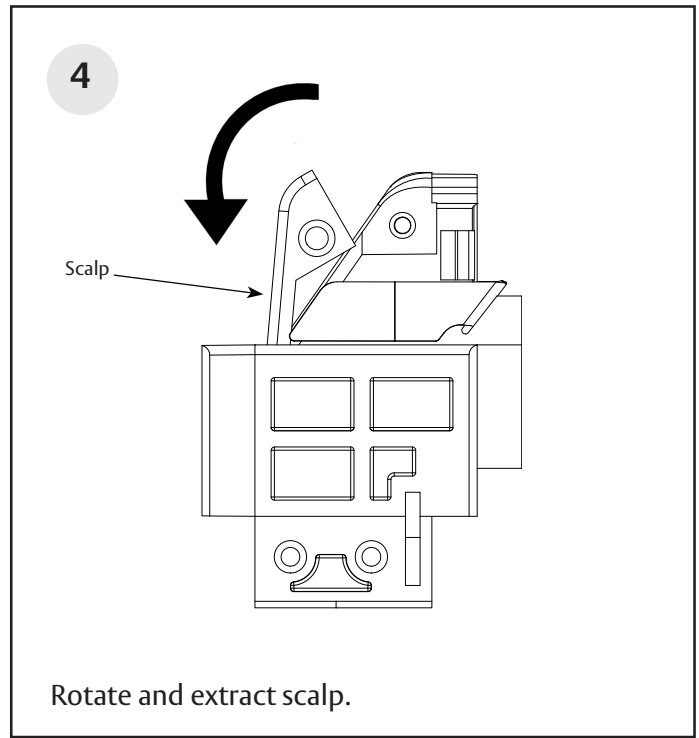
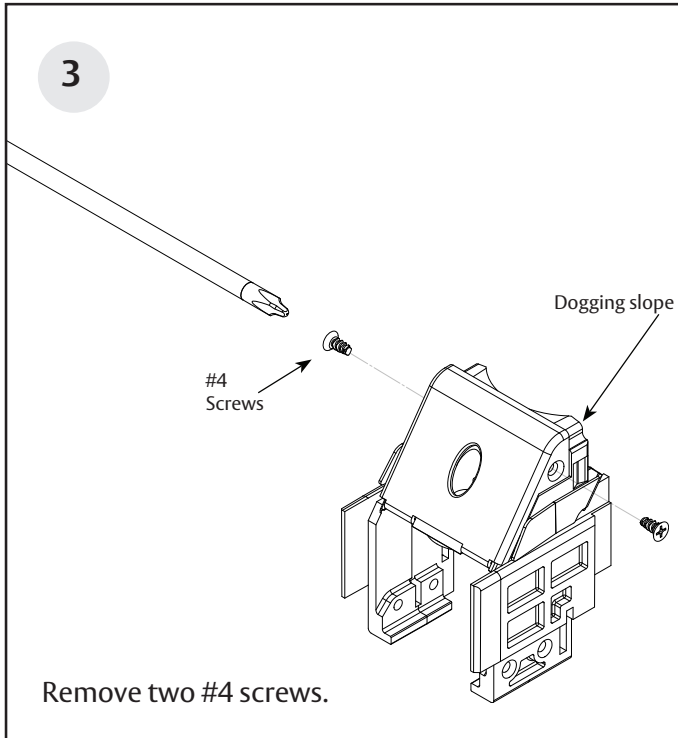

Cylinder Dogging

PE80 Series Exit Devices

Installation Instructions

SARGENT

ASSA ABLOY

7

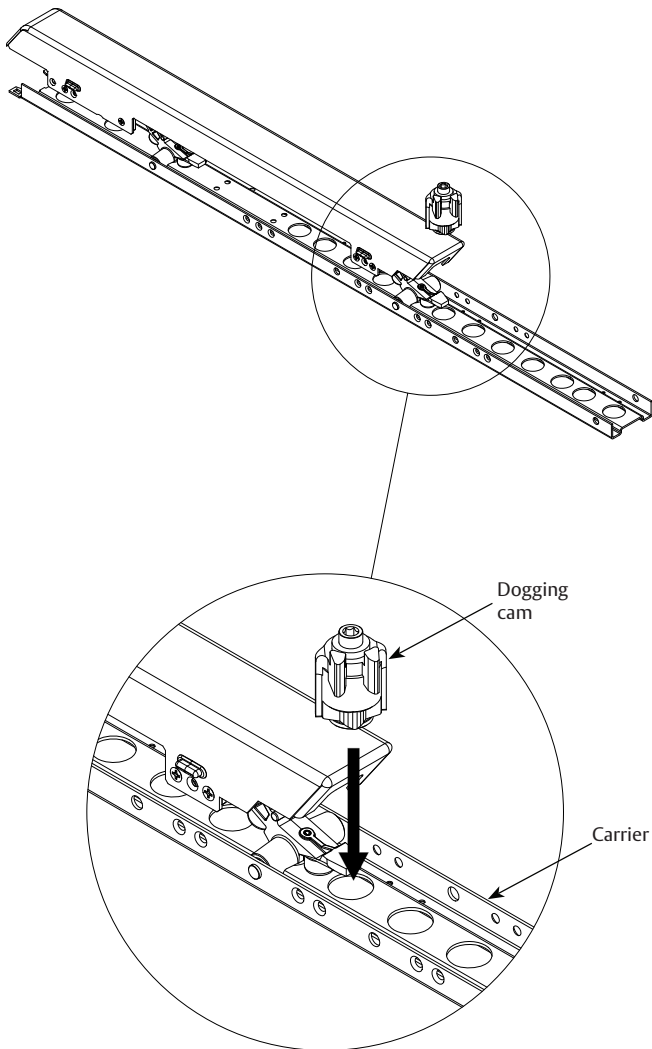

Place dogging cam in carrier hole.

8

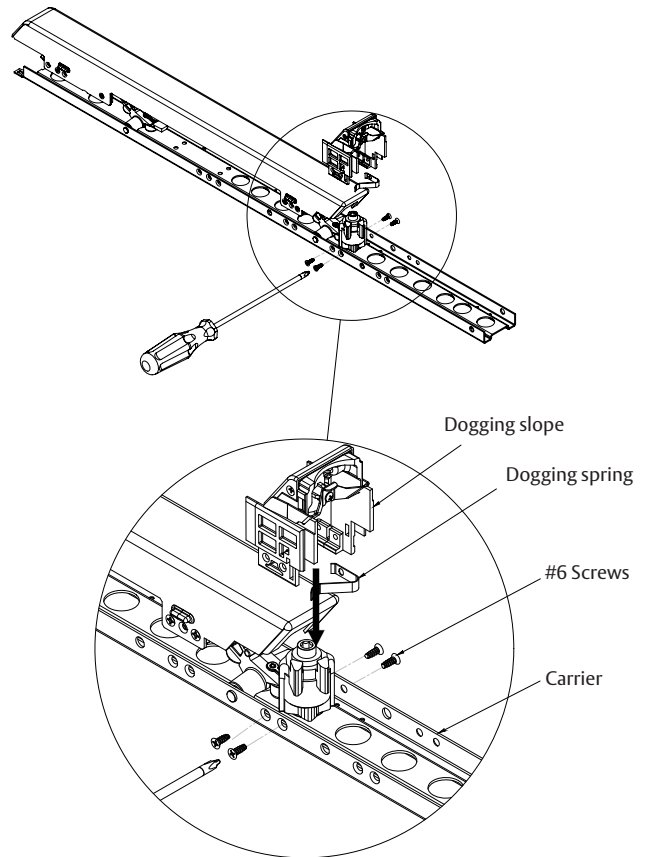

Place dogging spring outside of dogging slope.
Insert both on the carrier. Install four #6 screws.

Cylinder Dogging

PE80 Series Exit Devices

Installation Instructions

SARGENT

ASSA ABLOY

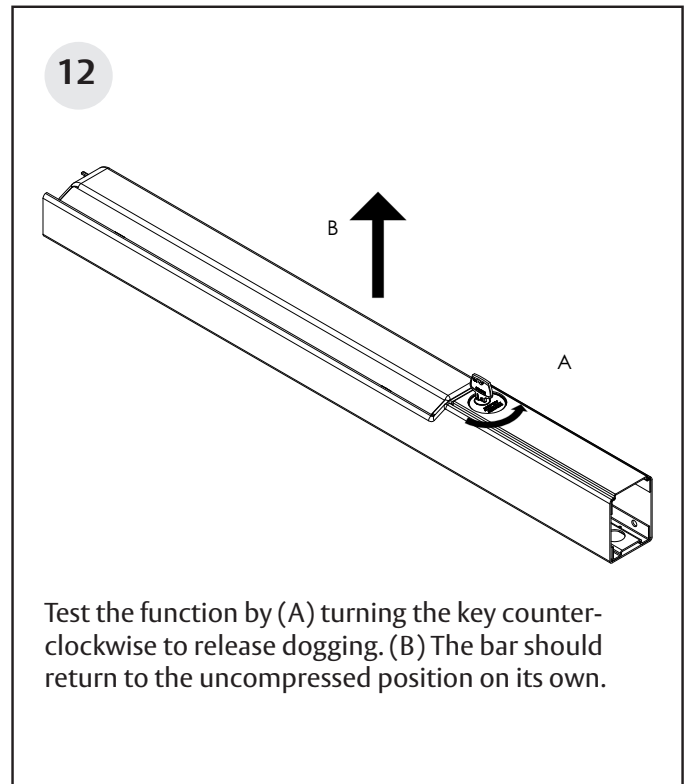
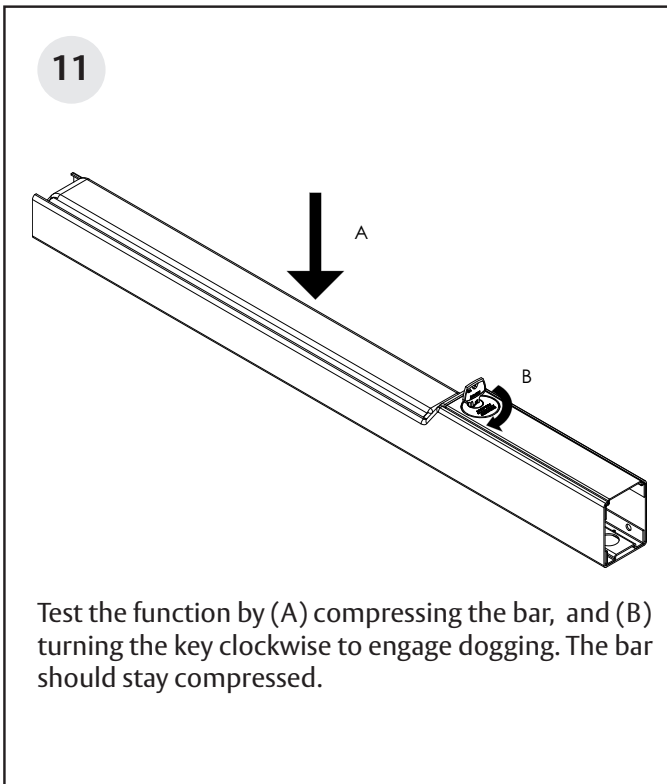
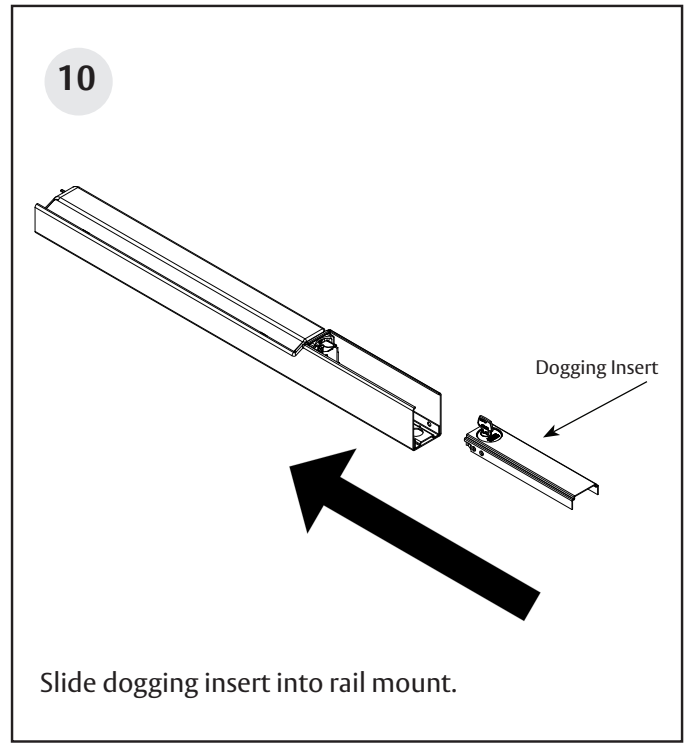
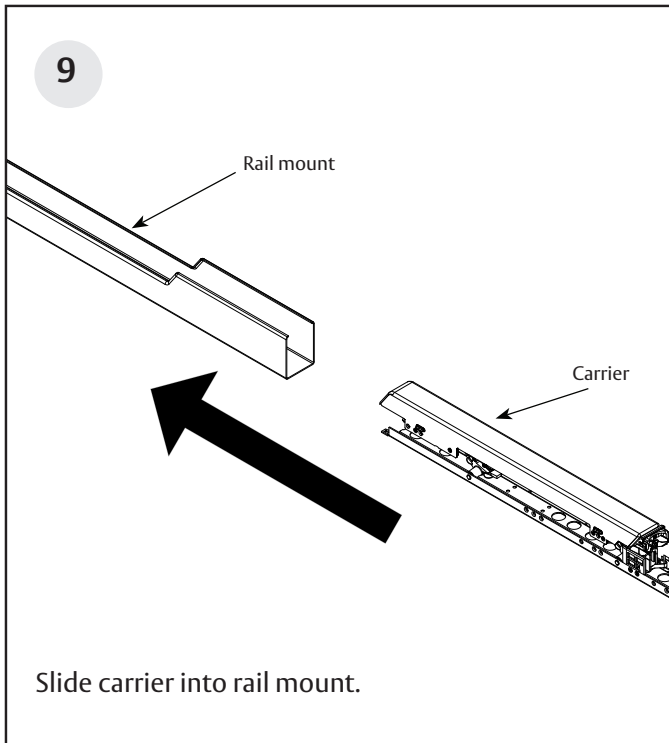

Cylinder Dogging

PE80 Series Exit Devices

Installation Instructions



Cylinder Dogging

PE80 Series Exit Devices

Installation Instructions

